

SHADOWLINE

LED LINEAR SUSPENSION TRACK SYSTEM
INSTALLATION INSTRUCTIONS

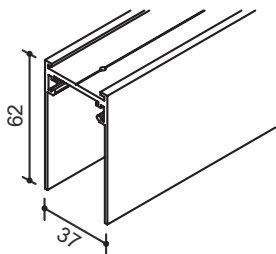

SUSPENSION MOUNTED TRACK - COMPONENTS



Product code	Length
10-TDS	1500mm
20-TDS	2000mm
30-TDS	2500mm

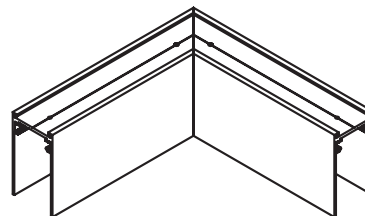

Product code	Length
50-TDS	Surface mounted Horizontal corner 89 x 89mm D.37mm

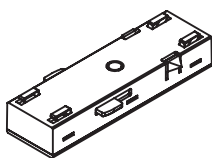

10-CDS
Straight circuit joint

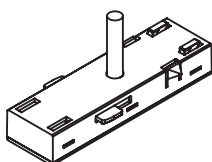

20-CDS
Straight circuit joint 2m power cable

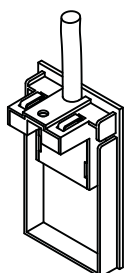

30-CDS
End cap 2m power cable

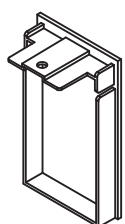

40-CDS
End cap

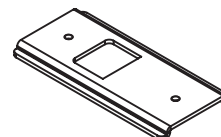

60-CDS
Surface mounted reinforced plate

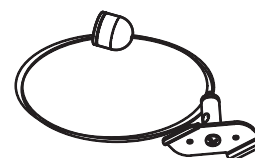

40-IDS
2 x 1500mm stainless steel hanging kit

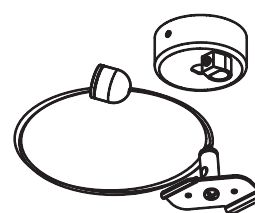

50-IDS
2 x 1500mm stainless steel hanging kit, 1 x power cable

SUSPENSION MOUNTED TRACK - INSTALL INSTRUCTIONS

1

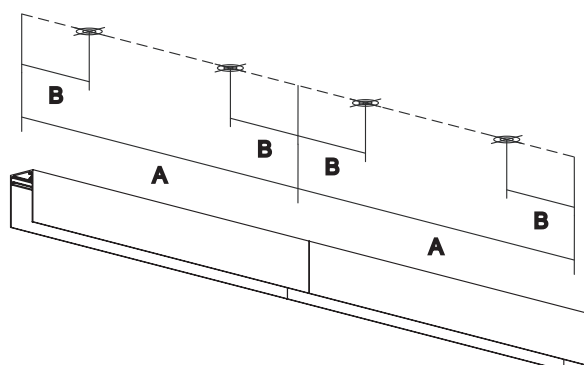

Product code

A

B

10-TDS	1500mm	110mm
20-TDS	2000mm	110mm
30-TDS	2500mm	110mm

2

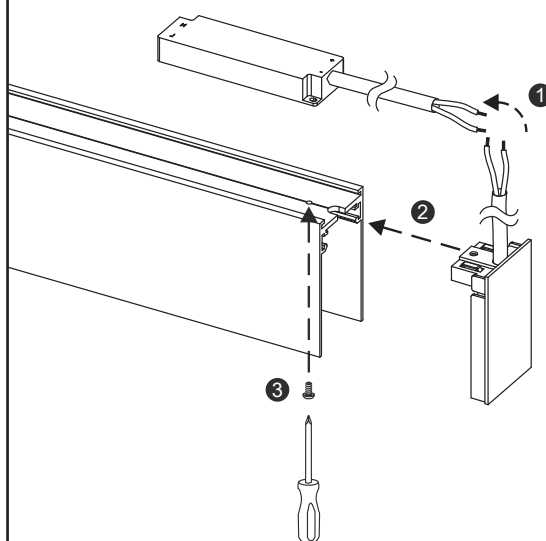

30-CDS End cap 2m power cable

3

20-CDS
Recessed straight
circuit joint
2m power cable

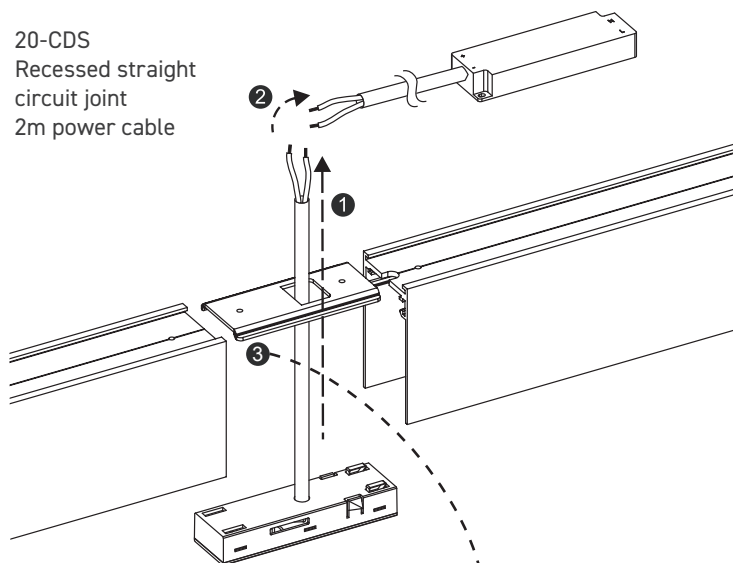

60-CDS
Surface mounted
reinforced plate

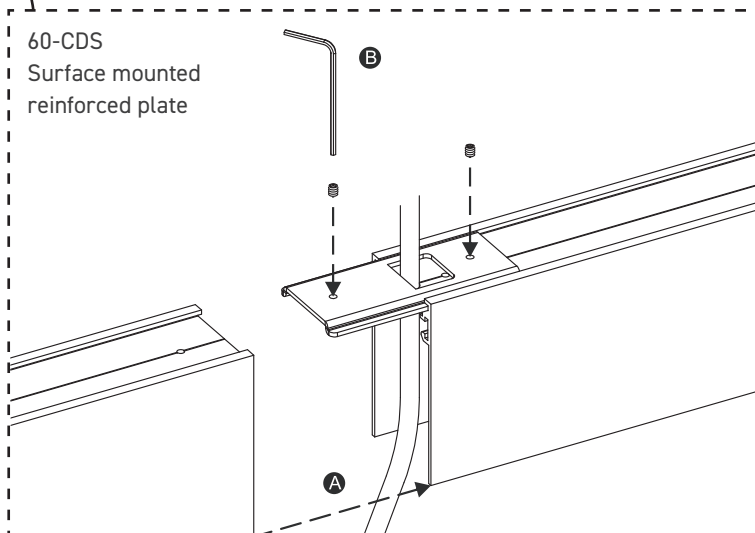

SUSPENSION MOUNTED TRACK - INSTALL INSTRUCTIONS

4

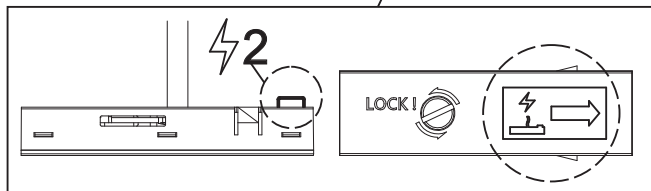
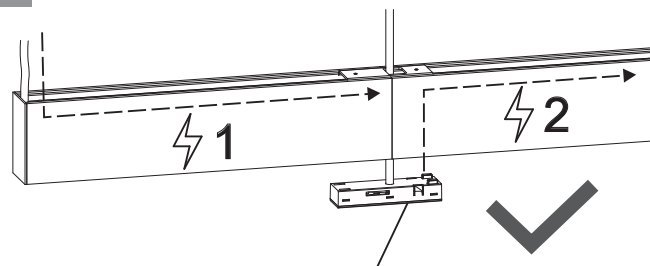

20-CDS Recessed straight circuit joint 2m power cable

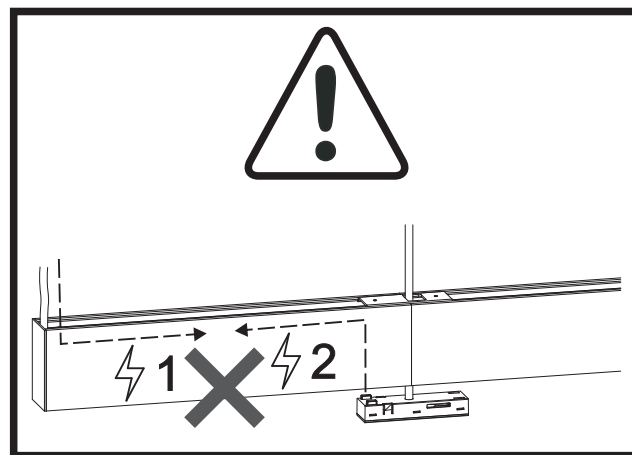

5

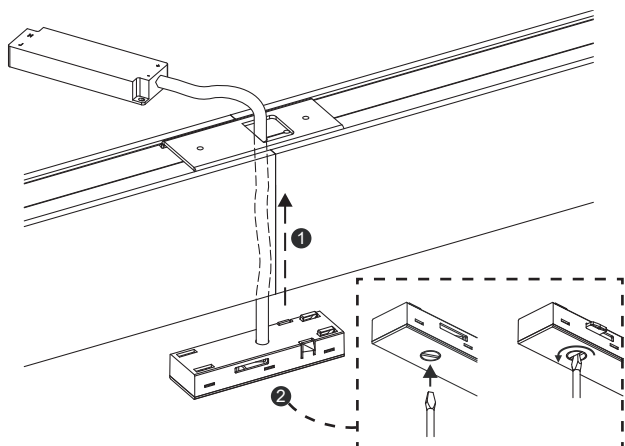

20-CDS
Recessed straight circuit joint 2m power cable

6

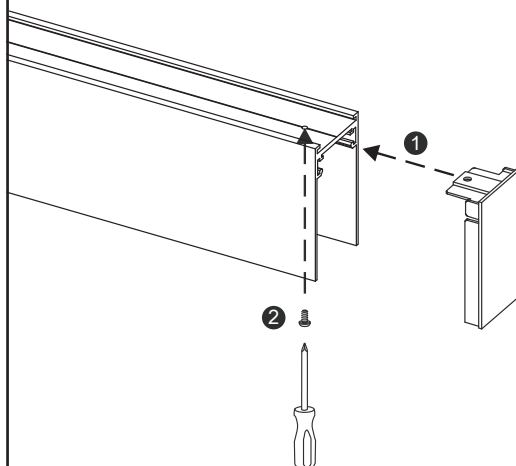

40-CDS End cap

SUSPENSION MOUNTED TRACK - INSTALL INSTRUCTIONS

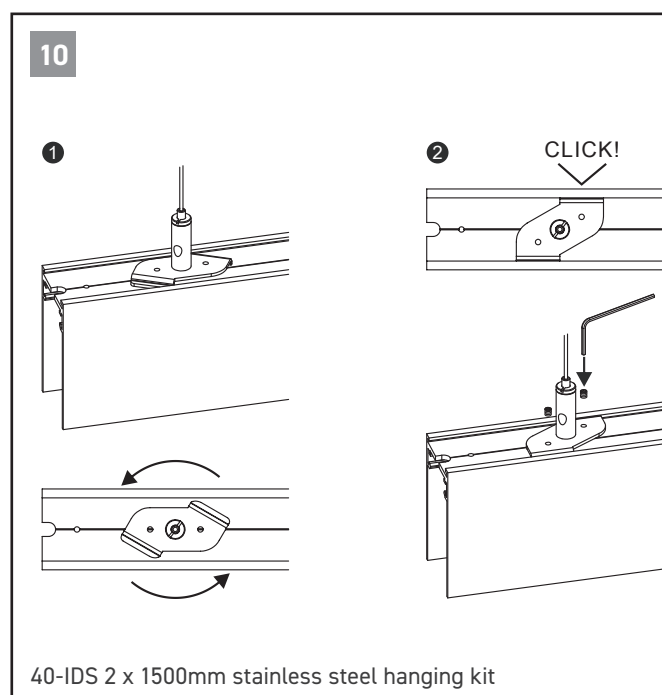
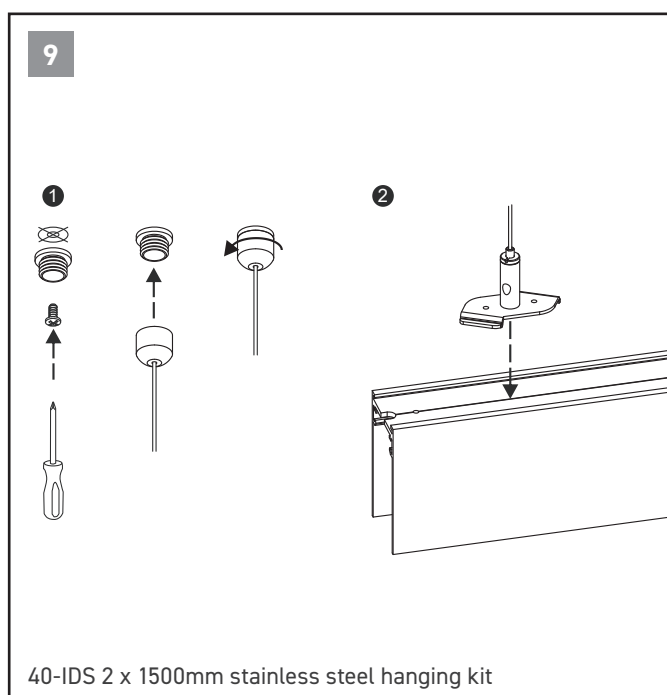
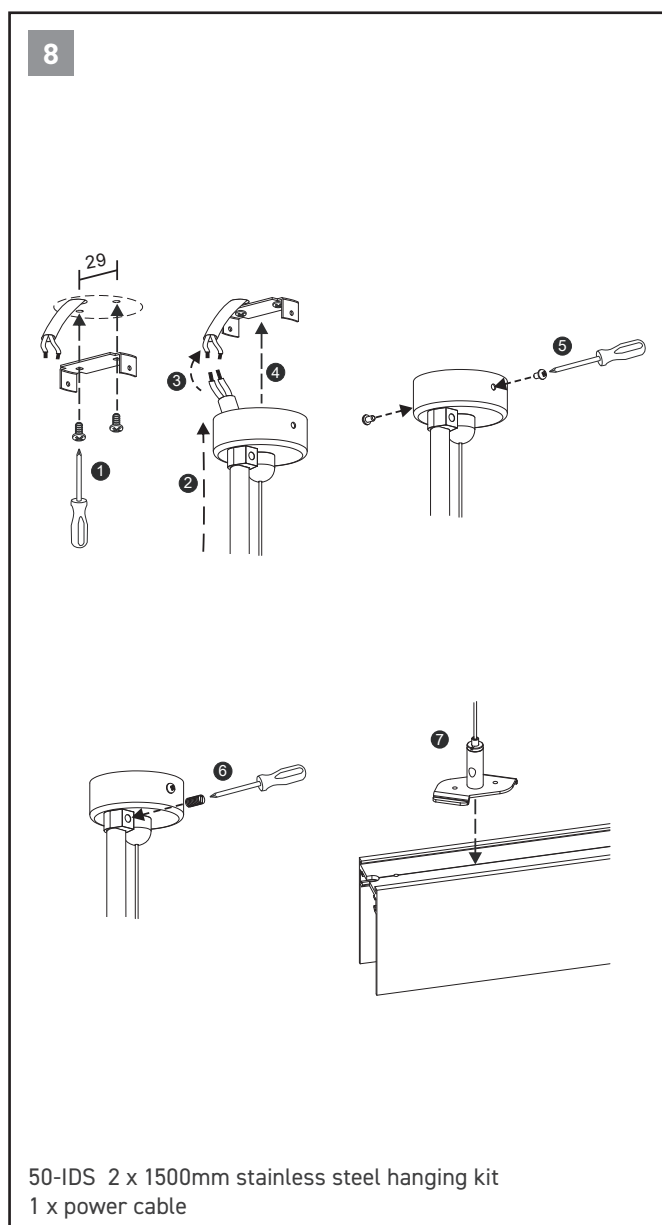
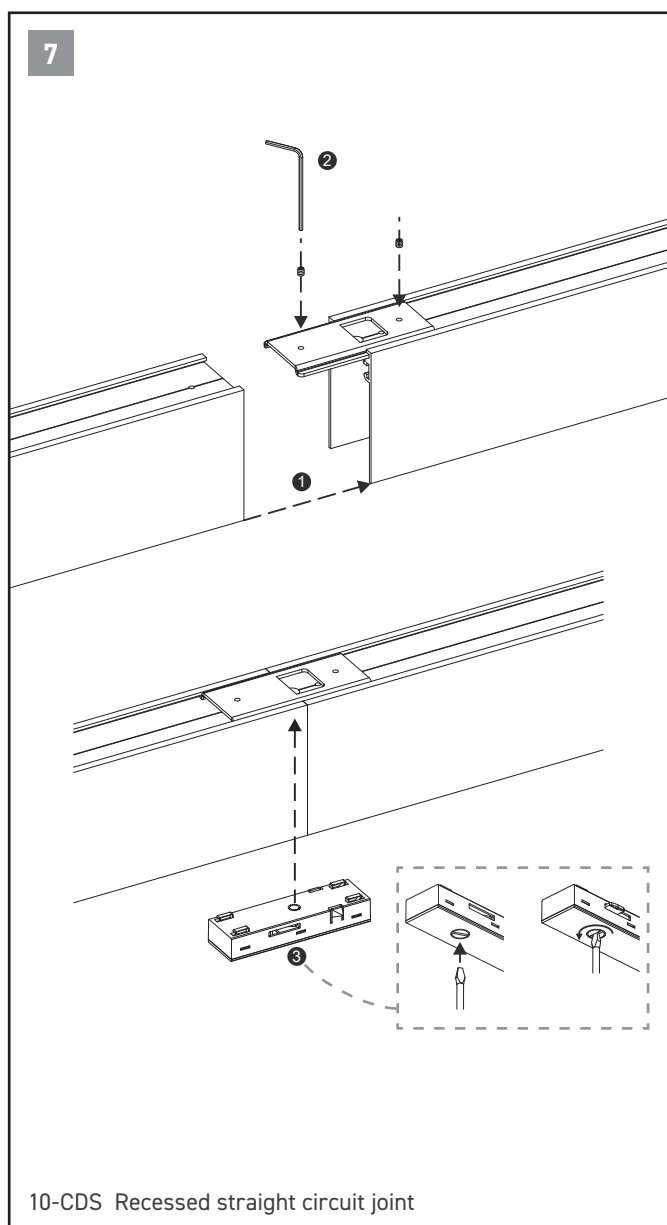

SUSPENSION MOUNTED TRACK - INSTALL INSTRUCTIONS

11

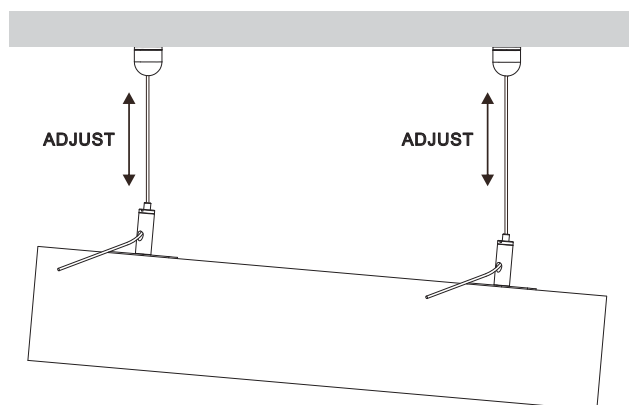

40-IDS 2 x 1500mm stainless steel hanging kit

12

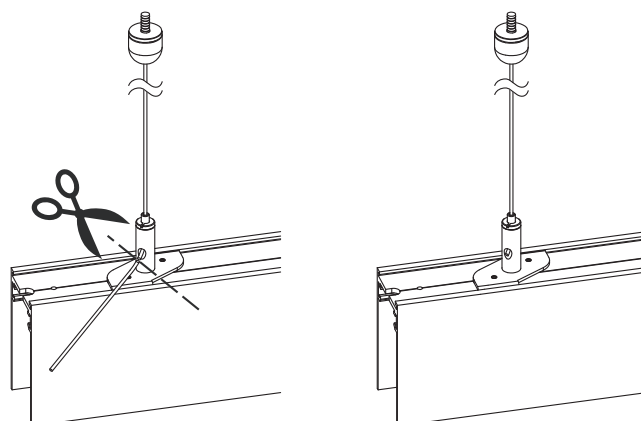

40-IDS 2 x 1500mm stainless steel hanging kit



01189 889414



sales@darklightdesign.com



darklightdesign.com

Darklight Design
Unit 10 Brookside Business Centre
Church Road
Swallowfield
Reading
Berkshire
RG7 1TH