

concrete ring + cap installation instruction

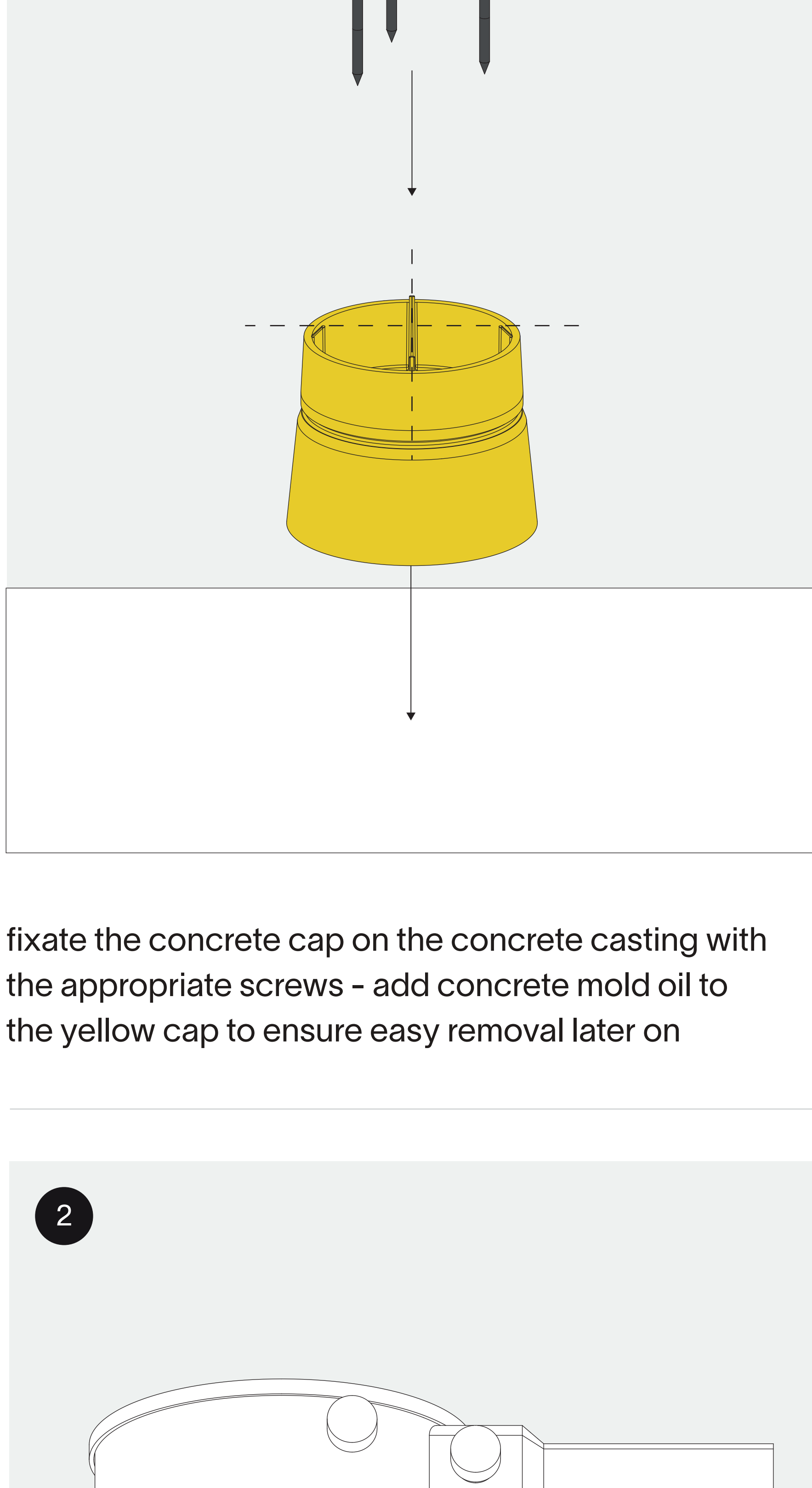

fixate the concrete cap on the concrete casting with the appropriate screws - add concrete mold oil to the yellow cap to ensure easy removal later on

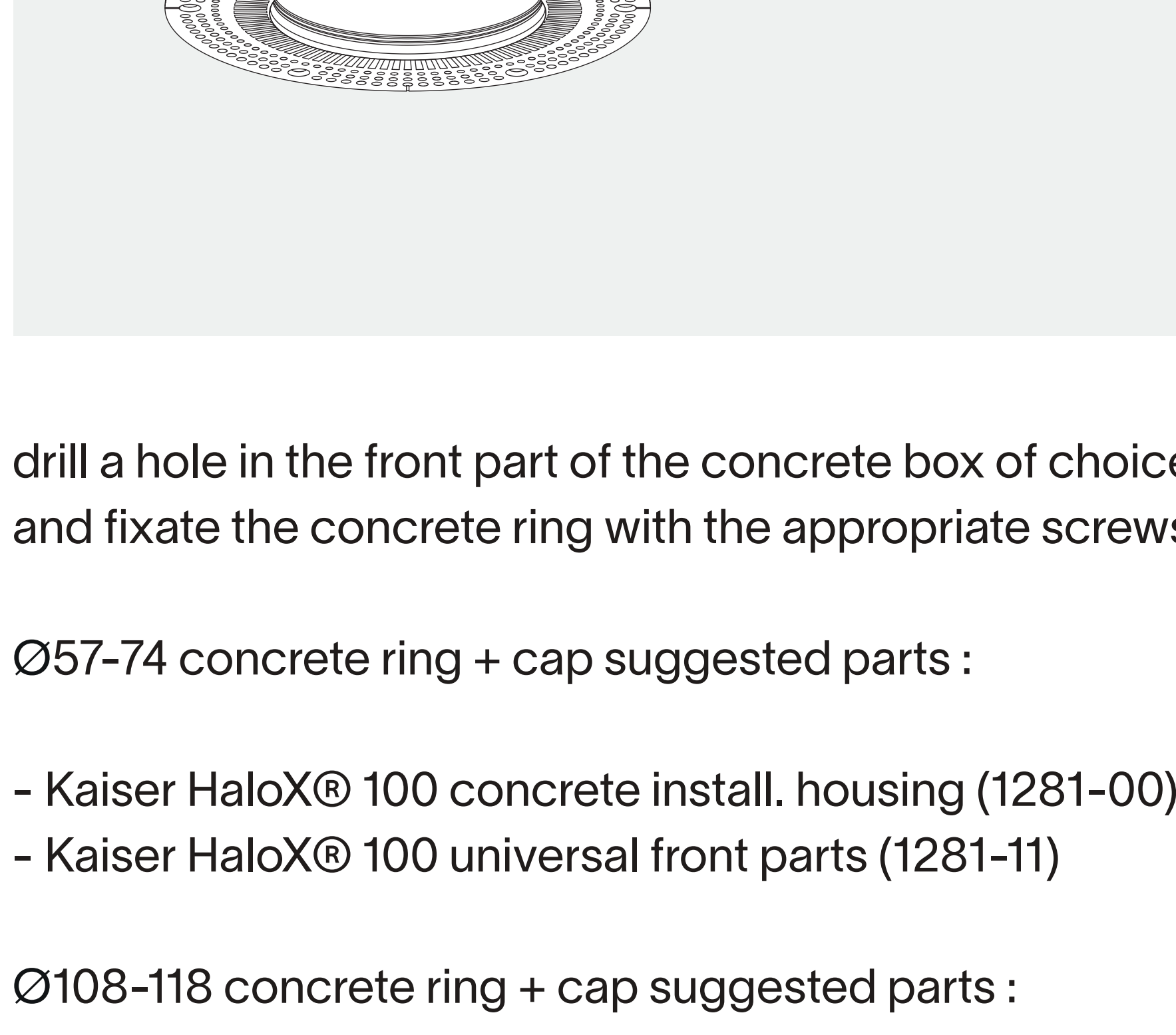

drill a hole in the front part of the concrete box of choice and fixate the concrete ring with the appropriate screws

Ø57-74 concrete ring + cap suggested parts :

- Kaiser HaloX® 100 concrete install. housing (1281-00)
- Kaiser HaloX® 100 universal front parts (1281-11)

Ø108-118 concrete ring + cap suggested parts :

- Kaiser HaloX® 180 concrete install. housing (1282-00)
- Kaiser HaloX® 180 universal front parts (1282-11)

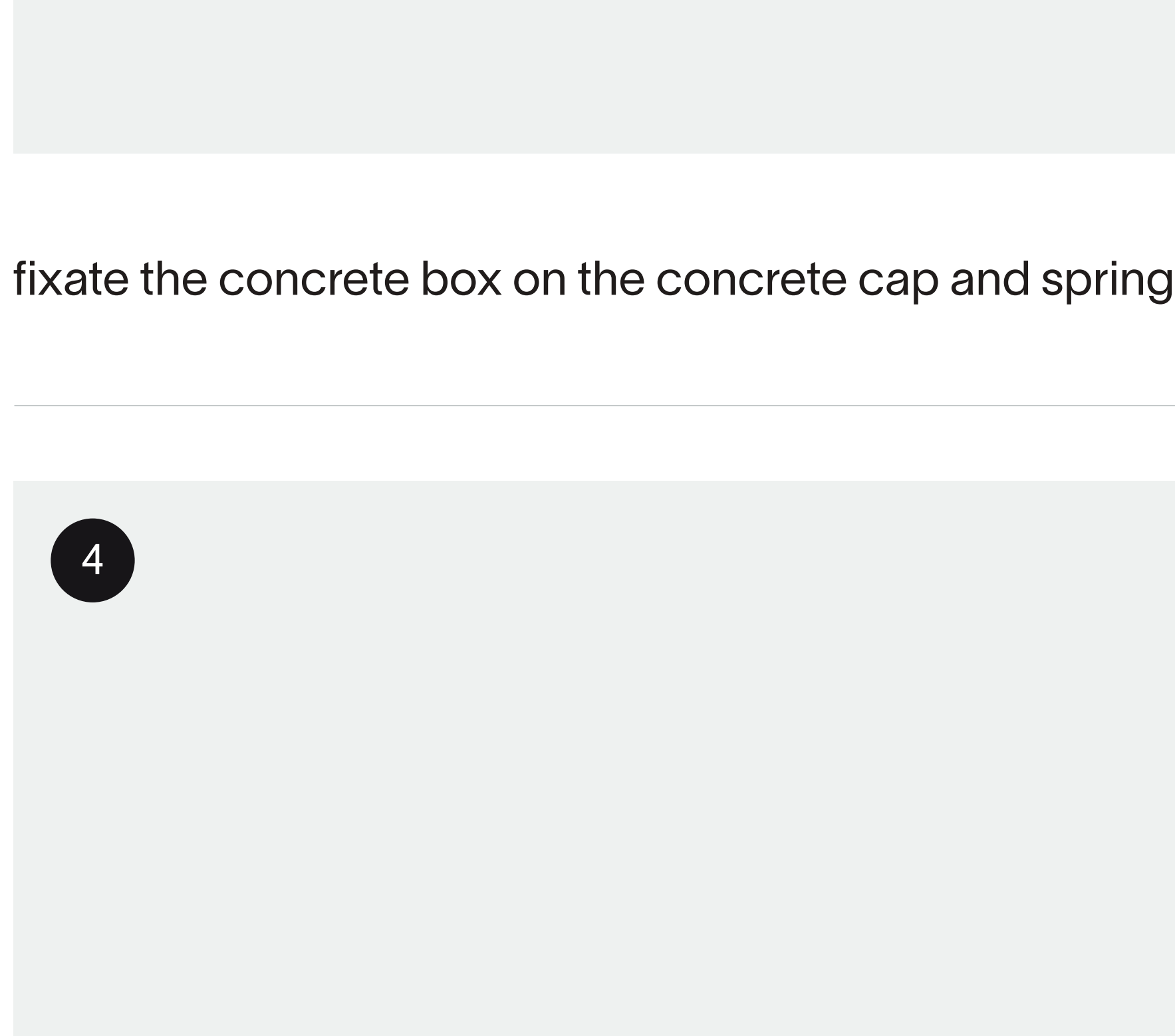

fixate the concrete box on the concrete cap and spring

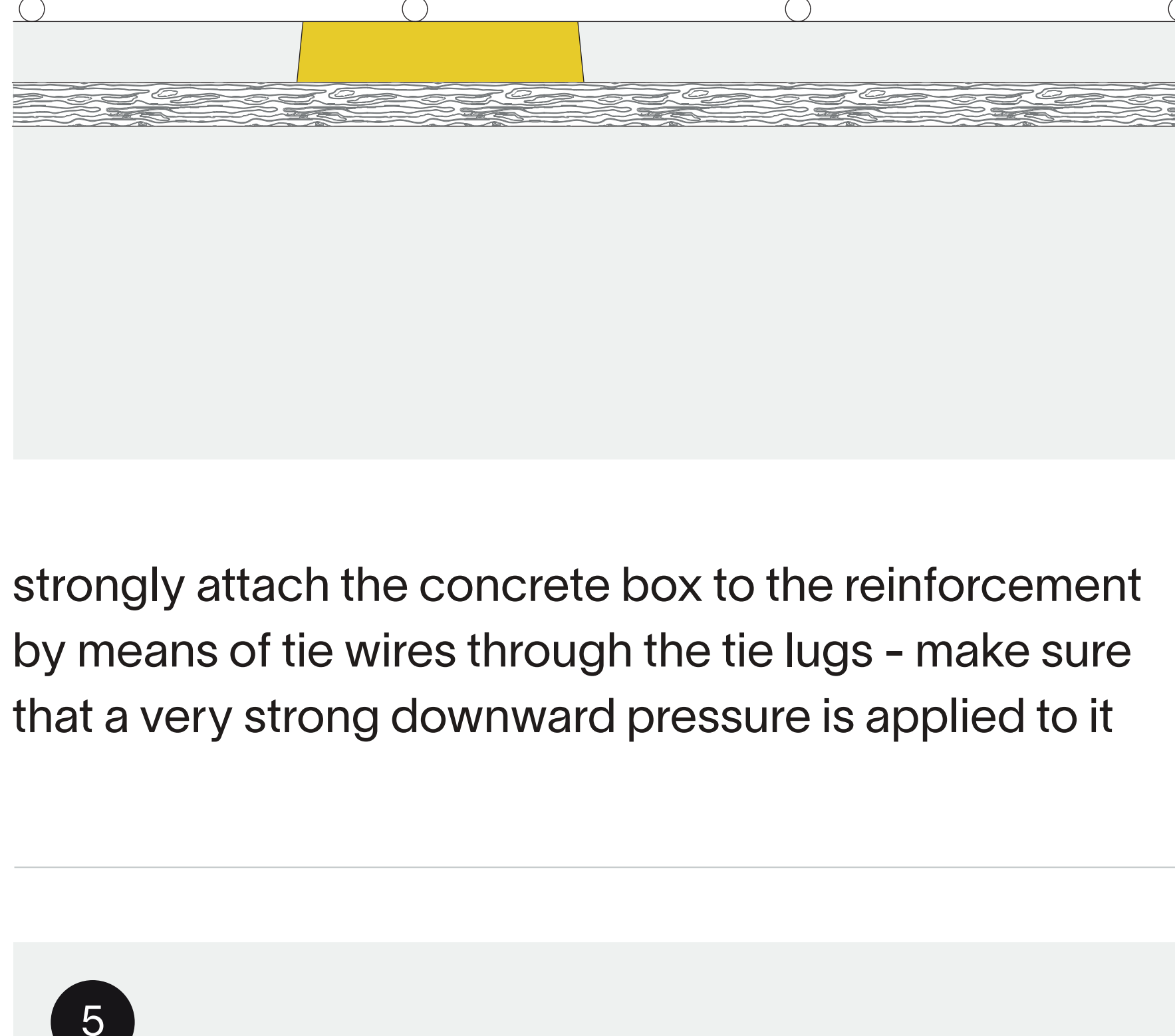

strongly attach the concrete box to the reinforcement by means of tie wires through the tie lugs - make sure that a very strong downward pressure is applied to it

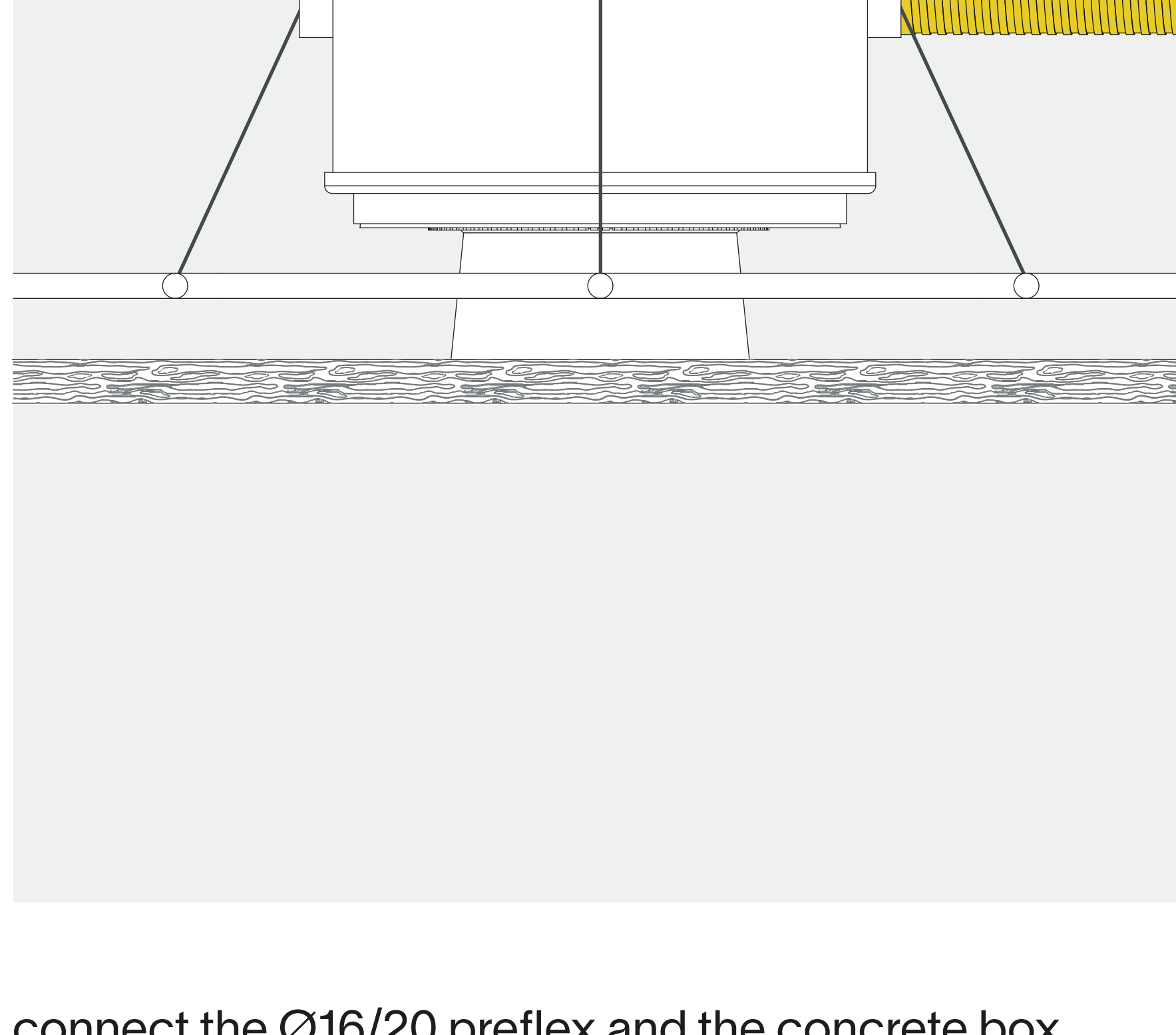

connect the Ø16/20 preflex and the concrete box make sure to add 300mm of wire into the concrete box

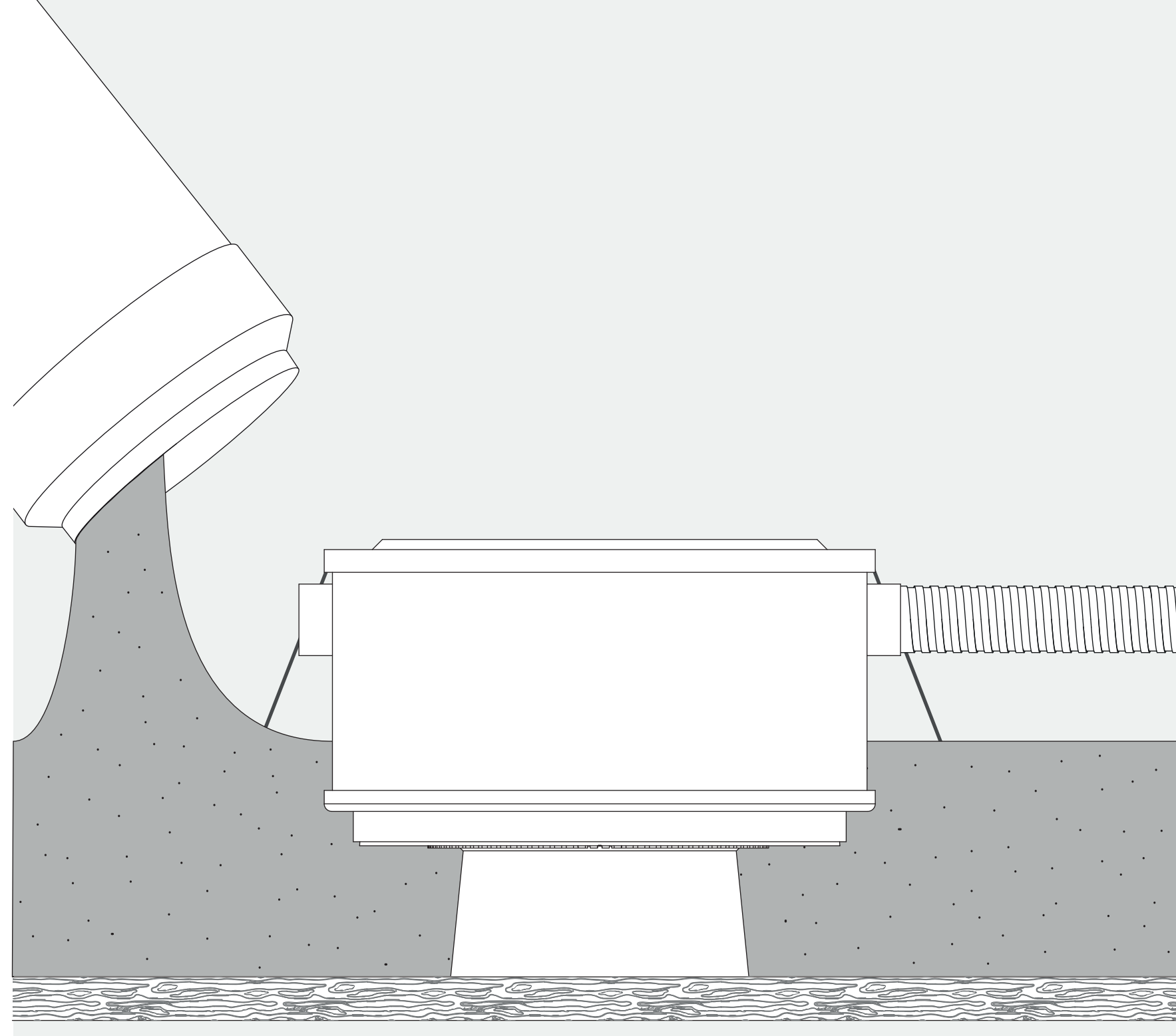

pour the concrete without lifting up the concrete box

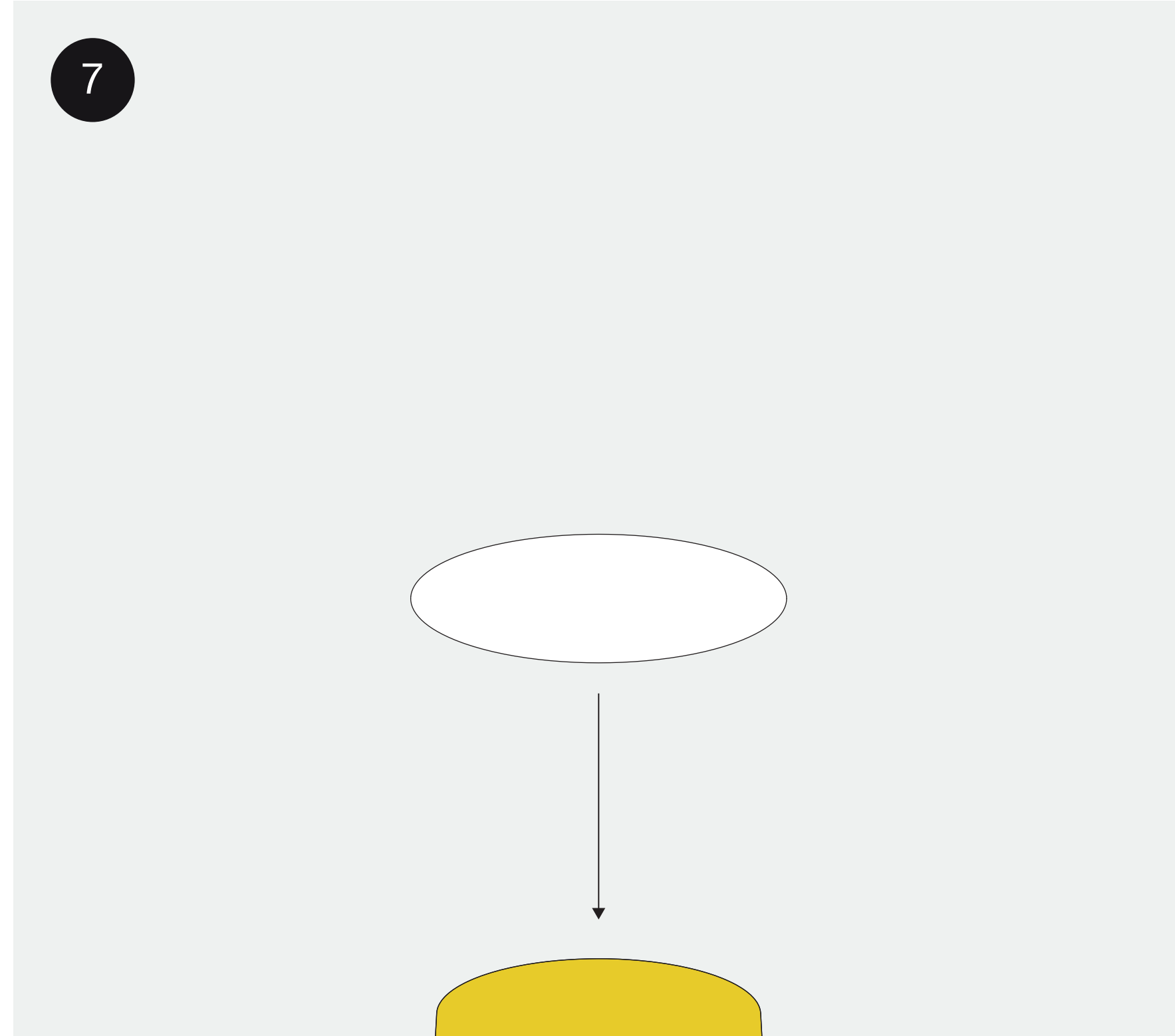

remove the concrete cap together with the casting

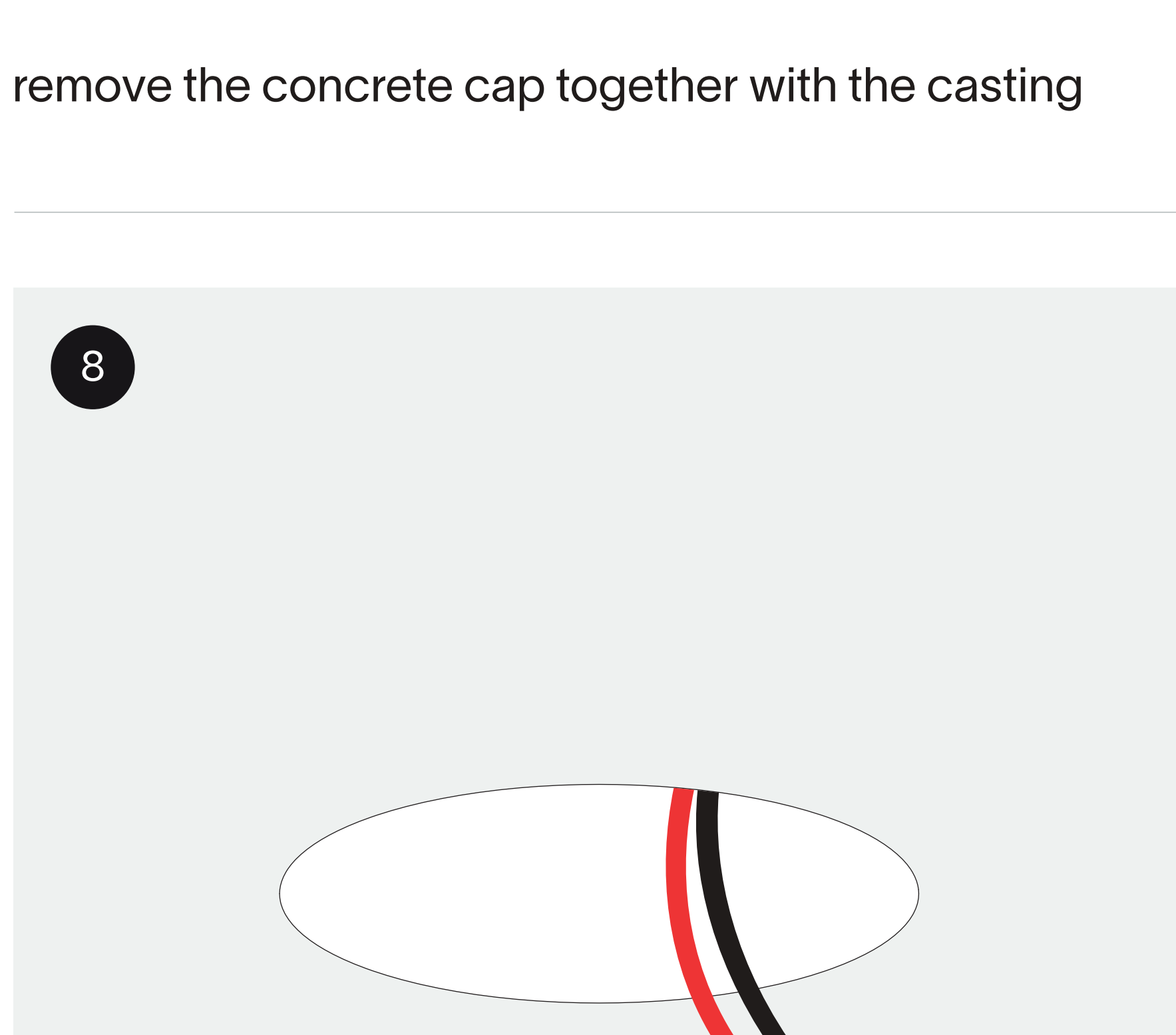

the fixture can now be installed

thank you for choosing prado