

TRACK 48V SYSTEM



ARKOSLIGHT®

TRACK 48V SYSTEM

TRIMLESS · SURFACE · SURFACE SHORT · SUSPENDED · SUSPENDED SHORT

ARKOSLIGHT®

TRACK 48V

TRACK 48V TRIMLESS

TRACK 48V SURFACE

TRACK 48V SURFACE SHORT

TRACK 48V SUSPENDED

TRACK 48V SUSPENDED SHORT





“Track 48V Surface” and *“Track 48V Surface Short”*
two track heights, two compatible product ranges.

— Wide product collection. One system, multiple lighting solutions.

— Miniaturization and formal minimalism: maximum integration into the architecture.

— Electrical safety, low voltage.

— Easy-to-install, without tools.

— Versatile: simple and manual location changes.

— Maximum perceived quality in details and finishings.

— Compatible with DALI control systems.



SMALLER SIZE, IMPROVED INTEGRATION

The track 48V dimensions allow a perfect integration improved of the lighting into the architectural space. The trimless version appears as a narrow minimalist line, while the surface and pendant variants adopt a sober and discrete aspect.

The 'short' alternatives have been designed to achieve significant miniaturization and, once installed they remain as a natural part of the ceiling- offering a perfect integration that reduces the presence of the track to the very minimum.



ELECTRICAL SAFETY

The low voltage of the track is synonym of electrical safety for the user, permitting greater versatility and ease-of-use, and installation. The luminaires can be installed without having to disconnect the track from the mains, and they can be manipulated directly by hand, without needing any protection means.

This advantage exists because the low voltage of track 48V is lower than the limit beyond which contact with electricity is harmful for the human being. The best technical lighting yield, with zero risks.

EASY-TO-INSTALL

There are few things that are easier to install than a luminaire on an Arkoslight low voltage track.

No tools are required. The product clip system can be gently pressed into the track by hand, where it remains secured and electrically supplied. As easy as pie.

Changing the product location is just as easy as the installation. A gentle pull suffices to remove it from its location, applying the same method as before to install it, as many times as you want.



PURITY AND ELEGANCE

The formal refinement of the 48V tracks, together with the elegant and minimalist sobriety of the luminaires for this system, give rise to an exquisite ensemble: simple, rational and with high perceived quality.

The meticulous finishing details can be seen in each piece of this low voltage system, where miniaturization demands special attention to be paid to the tiniest details of the construction of each track and luminaire.

DALI CONTROL

The Arkoslight 48V tracks are compatible with the DALI control system, which permits bidirectional communication between control device and luminaires, making it possible for the user to create scenes, regulate the system from DALI control devices, etc.

With the DALI control system and its ARK-Control wireless variants, the user has total control over the installation, with all the features available in low voltage alternatives. The 48V system does not mean relinquishing the leading edge in control for architectural lighting.

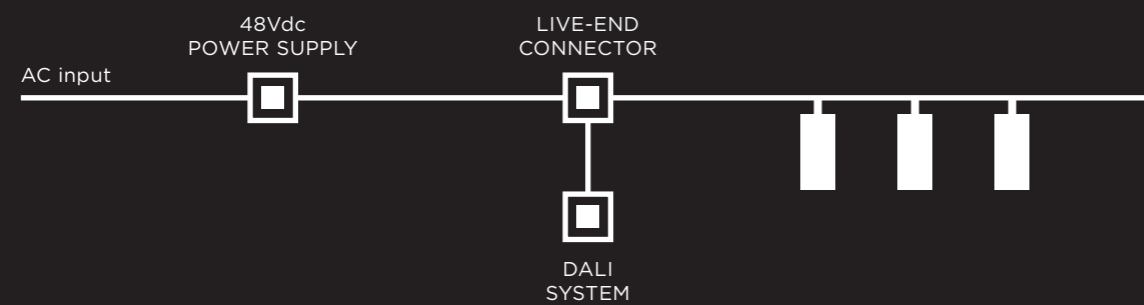

Casa Cruz | Design: Rubén Muedra Estudio de Arquitectura | Photography: Adrián Mora Maroto



VERSATILITY

The low voltage track permits covering all the lighting needs of a project, at the same time as it is able to adapt to the changes that can occur in the scene.

No matter the project need: accent, spotlight, ambient,... any lighting effect is possible with one of the solutions available for this Arkoslight low voltage system.

The scene and configuration possibilities are almost endless.

TRACK 48V SURFACE



TRACK 48V SURFACE SHORT



A VARIANT FOR EACH TRACK HEIGHT

The Arkoslight Track 48V system has two track heights, 54mm and 29mm. For projects whose priority is to reduce the lighting to a minimum, there are product variants that have been especially designed to adapt to the 'Short' track.

Gympact (Belgium) | Design: Salvator Store | Photography: Annelies Degroote





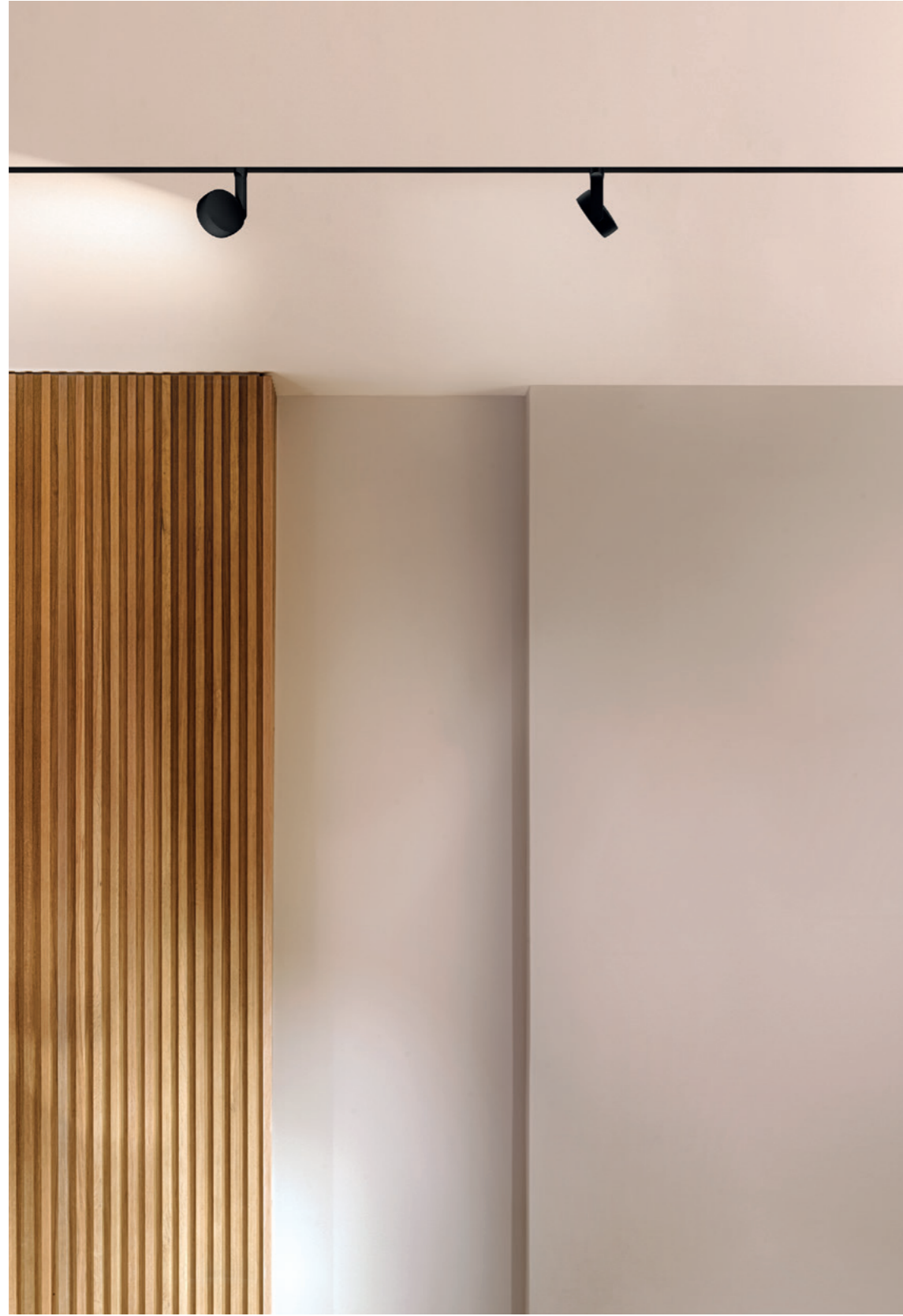

Bang & Olufsen Shop, Valencia (Spain) | Design: Alfredo Menzó | Photography: Héctor Rubio - Images Positive

TRACK 48V TECHNICAL SPECIFICATIONS

TRACK 48V

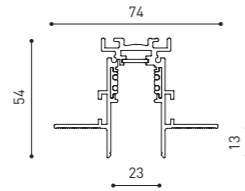
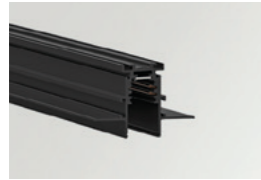

TRACK 48V TRIMLESS

TRACK 48V TRIMLESS 1m	A338-01-00-	N
TRACK 48V TRIMLESS 2m	A338-02-00-	N
TRACK 48V TRIMLESS 3m	A338-03-00-	N
TRACK 48V TRIMLESS Corner 90° One Plane	A338-06-00-	N
TRACK 48V TRIMLESS Corner 90° Two Planes	A338-07-00-	N

PLASTERBOARD CEILING, MANDATORY THICKNESS 12,5mm.
RECOMMENDED FOR INSTALLATIONS WHERE THE PROFILE CAN BE
INSTALLED BEFORE THE FALSE PLASTERBOARD CEILING.



TRACK 48V TRIMLESS Corner 90° One Plane

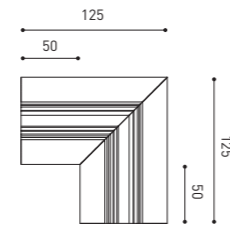

*Electrical connection not included

TRACK 48V TRIMLESS Corner 90° Two Planes

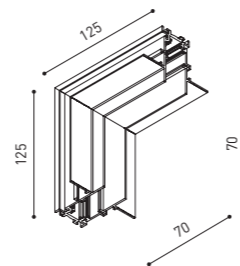

*Electrical connection not included

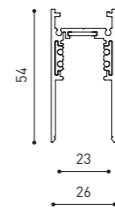

TRACK 48V SURFACE

TRACK 48V SURFACE 1m	A338-11-00-	N
TRACK 48V SURFACE 2m	A338-12-00-	N
TRACK 48V SURFACE 3m	A338-13-00-	N
TRACK 48V SURFACE Corner 90° One Plane	A338-14-00-	N



TRACK 48V SURFACE Corner 90° One Plane

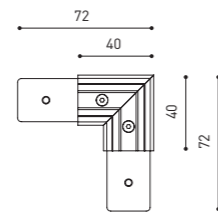

*Electrical connection not included

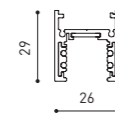

TRACK 48V SURFACE SHORT

TRACK 48V SURFACE SHORT 1m	A338-21-00-	N
TRACK 48V SURFACE SHORT 2m	A338-22-00-	N
TRACK 48V SURFACE SHORT 3m	A338-23-00-	N
TRACK 48V SURFACE SHORT Corner 90° One Plane	A338-24-00-	N



TRACK 48V SURFACE SHORT Corner 90° One Plane

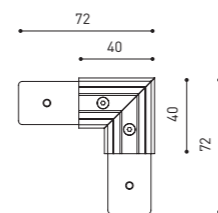

*Electrical connection not included

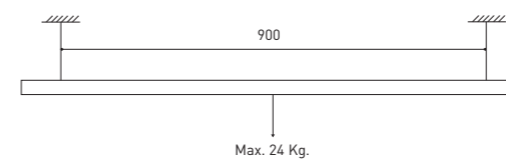

	P	V	D
CONSTANT VOLTAGE	0434-01-21	75W	48V
LED POWER SUPPLY	0434-01-22	150W	48V

DROP VOLTAGE TABLE

POWER (W)	CABLE SECTION (mm²)	CABLE LENGTH (m)			
		5	10	20	30
75	0,75	50	50	30	X
	1,5	50	50	50	50
150	0,75	40	15	X	X
	1,5	50	40	20	X

ACCESSORIES

TRACK 48V

ALL 48V TRACKS

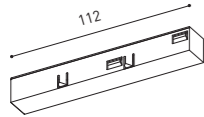

TRACK 48V Live-End Connector

A338-00-01- | N |

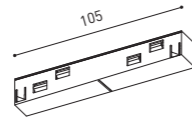

TRACK 48V Central Connector

A338-00-02- | N |

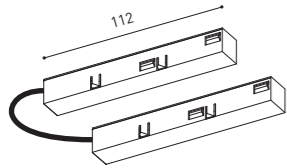

TRACK 48V Corner 90° Connector

A338-00-12- | N |

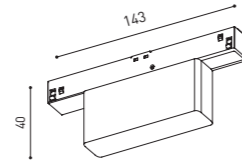

TRACK 48V Wireless Control

0434-01-31- | N | Casambi/AAG Stucchi App

0434-01-32- | N | AAG Stucchi App

TRIMLESS 48V



TRACK 48V TRIMLESS Short T-Bracket

A338-00-03



TRACK 48V TRIMLESS Clamp for M6 ROD

A338-00-09

*See accessories quantities

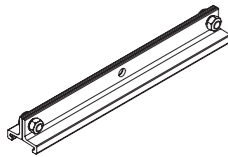

TRACK 48V TRIMLESS Long T-Bracket

A338-00-04



TRACK 48V TRIMLESS Track Clamp

A338-00-10

*See accessories quantities

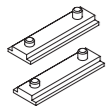

TRACK 48V TRIMLESS Straight Joiners (2 units)

A338-00-05



TRACK 48V TRIMLESS Suspension Kit

A338-00-08

*See accessories quantities

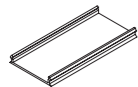

TRACK 48V TRIMLESS Plaster Installation Guard 1m

A338-00-21

*** SUGGESTED MOUNTING ACCESSORIES QUANTITIES**

1000mm - 2 Pcs.

2000mm - 3 Pcs.

3000mm - 4 Pcs.

SURFACE, SUSPENSION, SURFACE SHORT & SUSPENSION SHORT 48V

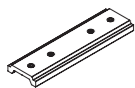

TRACK 48V SURFACE Straight Joiner

A338-00-11- | N |

COLOUR | N ■ RAL 9005 |

ACCESSORIES

TRACK 48V

TRIMLESS, SURFACE & SUSPENSION 48V



TRACK 48V TRIMLESS & SURFACE End

A338-00-06- | N |



TRACK 48V TRIMLESS & SURFACE End Feed

A338-00-07- | N |

SURFACE SHORT & SUSPENSION SHORT 48V



TRACK 48V SURFACE SHORT End

A338-00-18- | N |



TRACK 48V SURFACE SHORT End Feed

A338-00-19- | N |

SURFACE & SURFACE SHORT 48V

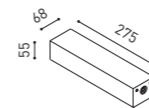

TRACK 48V Power Supply Case

A338-00-20- | N |



*To be installed aside 48V Surface Tracks
Power supply not included

SUSPENSION & SUSPENSION SHORT 48V

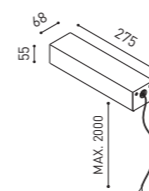

TRACK 48V Wired Power Supply Case

A338-00-22- | N |



A338-00-23- | N |



*Power supply not included

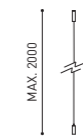

TRACK 48V SURFACE Suspension Kit (2 units)

A338-00-15- | N |

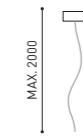

TRACK 48V SURFACE Suspension Feed Kit

A338-00-16- | N |



A338-00-17- | N |



*For remote power supply

COLOUR | N ■ RAL 9005 |



A RANGE THAT MATCHES ITS FEATURES

Arkoslight offers a complete range for your low voltage track. Spotlights, pendant luminaires, diffuse light modules... the variety of solutions, formats and sizes of luminaires is so extensive that it can respond to the needs of the most demanding interior designers, architects or lighting designers.

48V SYSTEM
SIX 48V



		+RE	P	CCT	Beam	I	Flux	LOR
SIX L 48V	A329-0- ∅ -10- WT NT -S	24,5W	2700K	17°	700mA	2850Lm	93%	
	A329-0- ∅ -11- WT NT -S	24,5W	3000K	17°	700mA	2950Lm	93%	
	A329-0- ∅ -12- WT NT -S	24,5W	4000K	17°	700mA	3000Lm	93%	
	A329-0- ∅ -30- WT NT -S	24,5W	2700K	26°	700mA	2850Lm	93%	
	A329-0- ∅ -31- WT NT -S	24,5W	3000K	26°	700mA	2950Lm	93%	
	A329-0- ∅ -32- WT NT -S	24,5W	4000K	26°	700mA	3000Lm	93%	
	A329-0- ∅ -20- WT NT -S	24,5W	2700K	34°	700mA	2850Lm	90%	
	A329-0- ∅ -21- WT NT -S	24,5W	3000K	34°	700mA	2950Lm	90%	
	A329-0- ∅ -22- WT NT -S	24,5W	4000K	34°	700mA	3000Lm	90%	



∅	*OPTIONS
1	No DIM
2	DIM DALI

+RE	REF. ENDING	EXAMPLE
∅	Track 48V	A3290110WT
-S	Track 48V Short	A3290110WT-S

ACCESSORY

SIX L High Chromatic LED**

NOT SOLD SEPARATELY

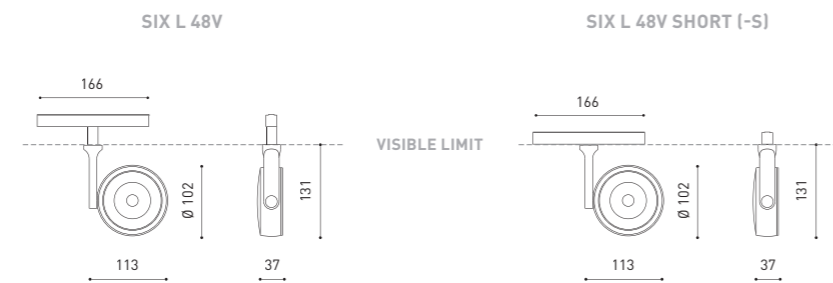

COLOUR | WT □ RAL 9016 | NT ■ RAL 9005 | MATERIAL | AL | PC | » 48

** ACCESSORY & COLOURS AFFECT THE LIGHTING PARAMETERS
+RE >> THE PRODUCTS FOR THE TRACK 48V SHORT, ADD "-S" AT THE END OF THE SALES REFERENCE
(AFTER THE LETTERS WHICH INDICATE THE COLOUR OF THE PRODUCT).

» PLEASE CONSULT



		+RE	P	CCT	Beam	I	Flux	LOR
SIX M 48V	A330-0- Ⓞ -10- WT NT -S	17W	2700K	19°	500mA	2050Lm	93%	
	A330-0- Ⓞ -11- WT NT -S	17W	3000K	19°	500mA	2130Lm	93%	
	A330-0- Ⓞ -12- WT NT -S	17W	4000K	19°	500mA	2160Lm	93%	
	A330-0- Ⓞ -20- WT NT -S	17W	2700K	28°	500mA	2050Lm	91%	
	A330-0- Ⓞ -21- WT NT -S	17W	3000K	28°	500mA	2130Lm	91%	
	A330-0- Ⓞ -22- WT NT -S	17W	4000K	28°	500mA	2160Lm	91%	
	A330-0- Ⓞ -30- WT NT -S	17W	2700K	38°	500mA	2050Lm	93%	
	A330-0- Ⓞ -31- WT NT -S	17W	3000K	38°	500mA	2130Lm	93%	
	A330-0- Ⓞ -32- WT NT -S	17W	4000K	38°	500mA	2160Lm	93%	

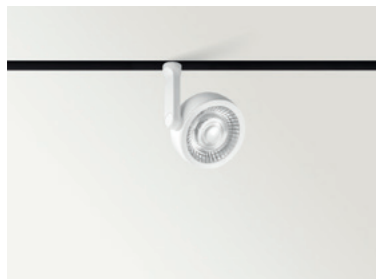
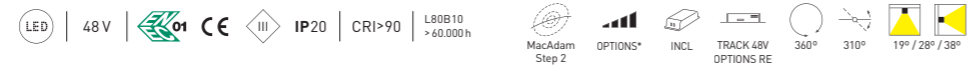

		+RE	P	CCT	Beam	I	Flux	LOR
SIX S 48V	A333-0- Ⓞ -10- WT NT -S	8,5W	2700K	17°	500mA	1030Lm	86%	
	A333-0- Ⓞ -11- WT NT -S	8,5W	3000K	17°	500mA	1070Lm	86%	
	A333-0- Ⓞ -12- WT NT -S	8,5W	4000K	17°	500mA	1100Lm	86%	
	A333-0- Ⓞ -20- WT NT -S	8,5W	2700K	24°	500mA	1030Lm	84%	
	A333-0- Ⓞ -21- WT NT -S	8,5W	3000K	24°	500mA	1070Lm	84%	
	A333-0- Ⓞ -22- WT NT -S	8,5W	4000K	24°	500mA	1100Lm	84%	
	A333-0- Ⓞ -30- WT NT -S	8,5W	2700K	34°	500mA	1030Lm	89%	
	A333-0- Ⓞ -31- WT NT -S	8,5W	3000K	34°	500mA	1070Lm	89%	
	A333-0- Ⓞ -32- WT NT -S	8,5W	4000K	34°	500mA	1100Lm	89%	

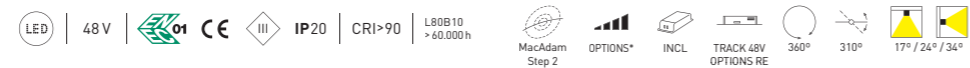

ACCESSORIES

SIX M High Chromatic LED**

SIX S High Chromatic LED**

NOT SOLD SEPARATELY



Ⓞ	*OPTIONS
1	No DIM
2	DIM DALI

+RE	REF. ENDING	EXAMPLE
⌀	Track 48V	A3300110WT
-S	Track 48V Short	A3300110WT-S

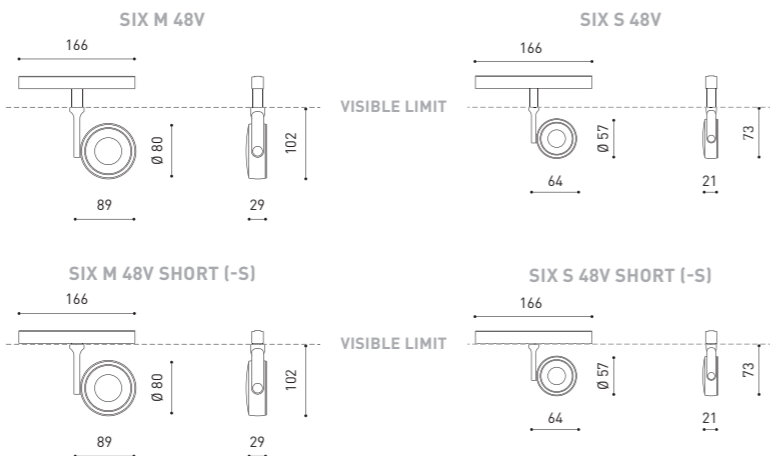

COLOUR | WT □ RAL 9016 | NT ■ RAL 9005 | MATERIAL | AL | PC | ⓘ » 48

** ACCESSORY & COLOURS AFFECT THE LIGHTING PARAMETERS
+RE >> THE PRODUCTS FOR THE TRACK 48V SHORT, ADD "-S" AT THE END OF THE SALES REFERENCE (AFTER THE LETTERS WHICH INDICATE THE COLOUR OF THE PRODUCT).

ⓘ » PLEASE CONSULT

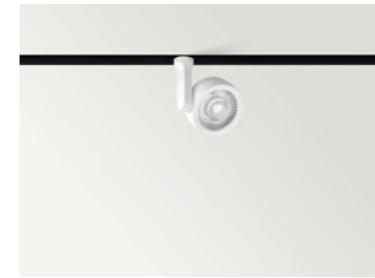

		+RE	P	CCT	Beam	I	Flux	LOR
SIX XS 48V	A335-0- Ⓞ -10- WT NT -S	4,5W	2700K	17°	500mA	470Lm	90%	
	A335-0- Ⓞ -11- WT NT -S	4,5W	3000K	17°	500mA	500Lm	90%	
	A335-0- Ⓞ -12- WT NT -S	4,5W	4000K	17°	500mA	530Lm	90%	
	A335-0- Ⓞ -20- WT NT -S	4,5W	2700K	23°	500mA	470Lm	86%	
	A335-0- Ⓞ -21- WT NT -S	4,5W	3000K	23°	500mA	500Lm	86%	
	A335-0- Ⓞ -22- WT NT -S	4,5W	4000K	23°	500mA	530Lm	86%	
	A335-0- Ⓞ -30- WT NT -S	4,5W	2700K	34°	500mA	470Lm	88%	
	A335-0- Ⓞ -31- WT NT -S	4,5W	3000K	34°	500mA	500Lm	88%	
	A335-0- Ⓞ -32- WT NT -S	4,5W	4000K	34°	500mA	530Lm	88%	



		+RE	P	CCT	Beam	I	Flux	LOR
SIX XS 48V Double	A335-1- Ⓞ -10- WT NT -S	9W	2700K	17°	500mA	2 X 470Lm	90%	
	A335-1- Ⓞ -11- WT NT -S	9W	3000K	17°	500mA	2 X 500Lm	90%	
	A335-1- Ⓞ -12- WT NT -S	9W	4000K	17°	500mA	2 X 530Lm	90%	
	A335-1- Ⓞ -20- WT NT -S	9W	2700K	23°	500mA	2 X 470Lm	86%	
	A335-1- Ⓞ -21- WT NT -S	9W	3000K	23°	500mA	2 X 500Lm	86%	
	A335-1- Ⓞ -22- WT NT -S	9W	4000K	23°	500mA	2 X 530Lm	86%	
	A335-1- Ⓞ -30- WT NT -S	9W	2700K	34°	500mA	2 X 470Lm	88%	
	A335-1- Ⓞ -31- WT NT -S	9W	3000K	34°	500mA	2 X 500Lm	88%	
	A335-1- Ⓞ -32- WT NT -S	9W	4000K	34°	500mA	2 X 530Lm	88%	



ACCESSORY

SIX XS High Chromatic LED**

NOT SOLD SEPARATELY



Ⓞ	*OPTIONS
1	No DIM
2	DIM DALI

+RE	REF. ENDING	EXAMPLE
⌀	Track 48V	A3350110WT
-S	Track 48V Short	A3350110WT-S

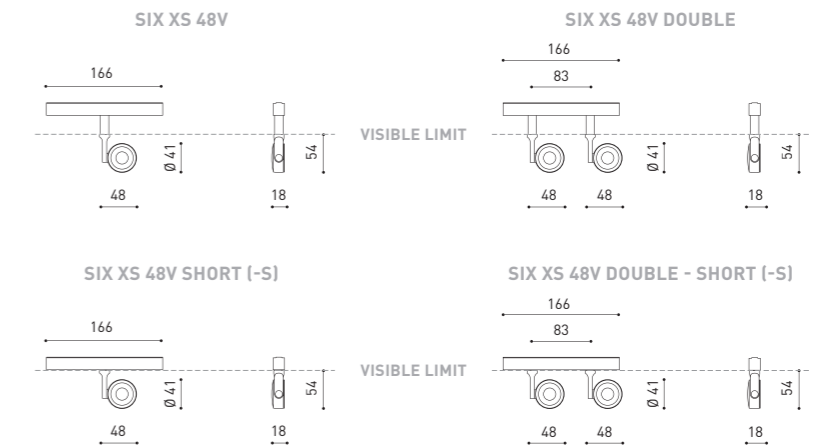

COLOUR | WT □ RAL 9016 | NT ■ RAL 9005 | MATERIAL | AL | PC | ⓘ » 48

** ACCESSORY & COLOURS AFFECT THE LIGHTING PARAMETERS
+RE >> THE PRODUCTS FOR THE TRACK 48V SHORT, ADD "-S" AT THE END OF THE SALES REFERENCE (AFTER THE LETTERS WHICH INDICATE THE COLOUR OF THE PRODUCT).

ⓘ » PLEASE CONSULT

48V SYSTEM
FIT 48V



		+RE	P	CCT	Beam	I	Flux	LOR
FIT Ø50 48V	A346-0- Ⓞ -10- WT NT -S	12W	2700K	15°	1050mA	1040Lm	85%	
	A346-0- Ⓞ -11- WT NT -S	12W	3000K	15°	1050mA	1120Lm	85%	
	A346-0- Ⓞ -20- WT NT -S	12W	2700K	28°	1050mA	1040Lm	82%	
	A346-0- Ⓞ -21- WT NT -S	12W	3000K	28°	1050mA	1120Lm	82%	
	A346-0- Ⓞ -30- WT NT -S	12W	2700K	47°	1050mA	1040Lm	80%	
	A346-0- Ⓞ -31- WT NT -S	12W	3000K	47°	1050mA	1120Lm	80%	

LED | 48V | CE | III | IP20 | CRI>90 | L80B10 >60.000h |
 MacAdam Step 2 | OPTIONS* | INCL | TRACK 48V OPTIONS RE | 360° | 90° | 15°/28°/47°

Ⓞ	*OPTIONS
1	No DIM
2	DIM DALI

+RE	REF. ENDING	EXAMPLE
Ø	Track 48V	A3460110WT
-S	Track 48V Short	A3460110WT-S

ACCESSORY

FIT Ø50 Anti-glare Honeycomb Louver ** A346-00-00
NOT SOLD SEPARATELY

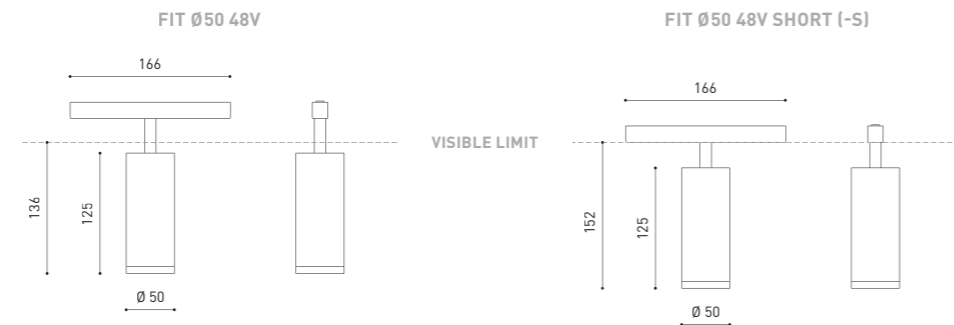

COLOUR | WT □ RAL 9016 | NT ■ RAL 9005 | MATERIAL | AL | PC | i » 48

** ACCESSORY AFFECTS THE LIGHTING PARAMETERS
+RE >> THE PRODUCTS FOR THE TRACK 48V SHORT, ADD "-S" AT THE END OF THE SALES REFERENCE (AFTER THE LETTERS WHICH INDICATE THE COLOUR OF THE PRODUCT). » PLEASE CONSULT

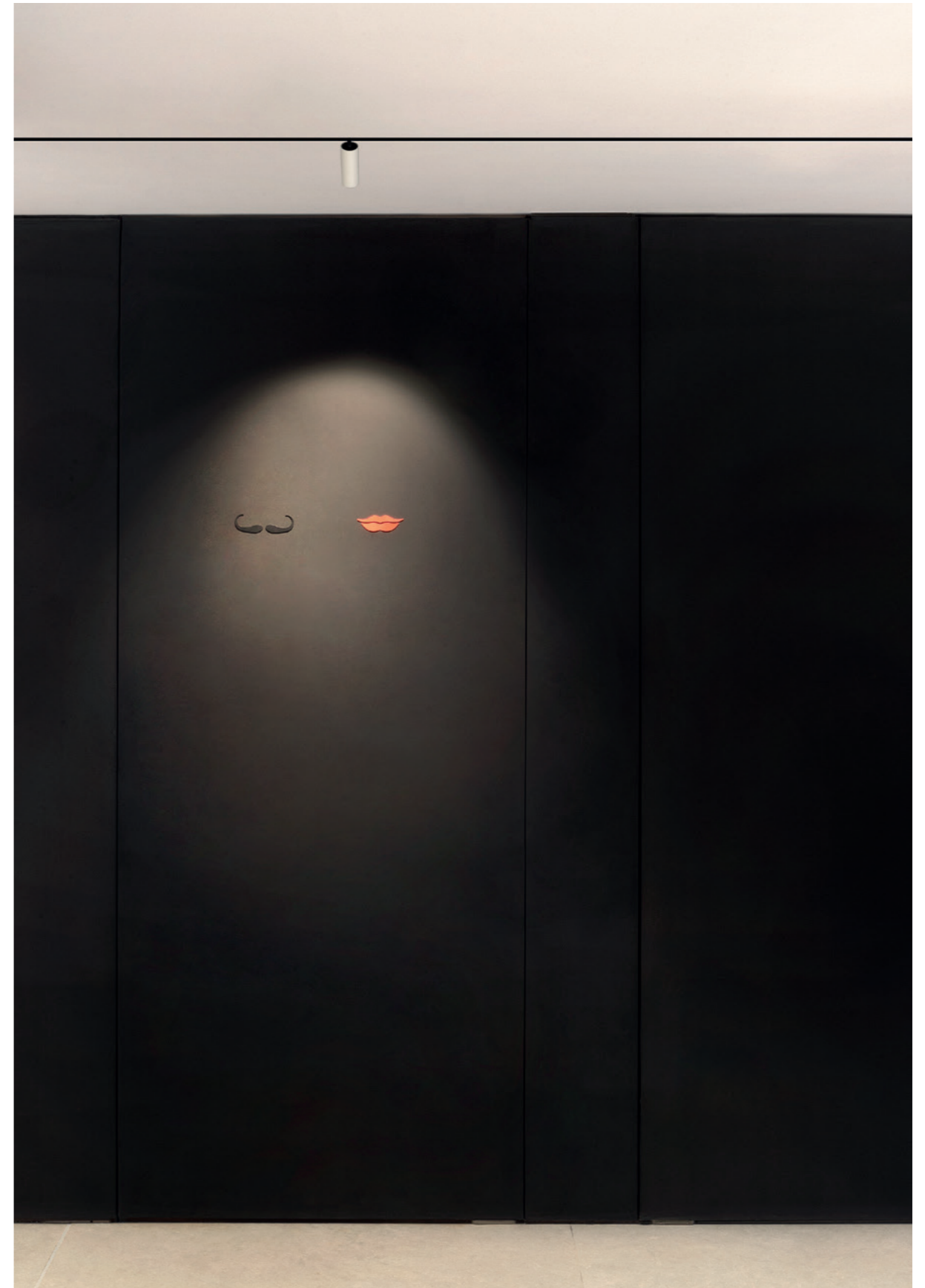



		+RE	P	CCT	Beam	I	Flux	LOR
FIT 035 48V	A345-0- 00 -10- WT NT -S	5,5W	2700K	19°	500mA	590Lm	82%	
	A345-0- 00 -11- WT NT -S	5,5W	3000K	19°	500mA	630Lm	82%	
	A345-0- 00 -20- WT NT -S	5,5W	2700K	29°	500mA	590Lm	80%	
	A345-0- 00 -21- WT NT -S	5,5W	3000K	29°	500mA	630Lm	80%	
	A345-0- 00 -30- WT NT -S	5,5W	2700K	38°	500mA	590Lm	80%	
	A345-0- 00 -31- WT NT -S	5,5W	3000K	38°	500mA	630Lm	80%	



		+RE	P	CCT	Beam	I	Flux	LOR
FIT 035 48V Double	A345-1- 00 -10- WT NT -S	11W	2700K	19°	500mA	2 x 590Lm	82%	
	A345-1- 00 -11- WT NT -S	11W	3000K	19°	500mA	2 x 630Lm	82%	
	A345-1- 00 -20- WT NT -S	11W	2700K	29°	500mA	2 x 590Lm	80%	
	A345-1- 00 -21- WT NT -S	11W	3000K	29°	500mA	2 x 630Lm	80%	
	A345-1- 00 -30- WT NT -S	11W	2700K	38°	500mA	2 x 590Lm	80%	
	A345-1- 00 -31- WT NT -S	11W	3000K	38°	500mA	2 x 630Lm	80%	



		+RE	P	CCT	Beam	I	Flux	LOR
FIT 020 48V	A344-0- 00 -10- WT NT -S	2,1W	2700K	12°	700mA	127Lm	87%	
	A344-0- 00 -11- WT NT -S	2,1W	3000K	12°	700mA	150Lm	87%	
	A344-0- 00 -20- WT NT -S	2,1W	2700K	30°	700mA	127Lm	88%	
	A344-0- 00 -21- WT NT -S	2,1W	3000K	30°	700mA	150Lm	88%	
	A344-0- 00 -30- WT NT -S	2,1W	2700K	54°	700mA	127Lm	81%	
	A344-0- 00 -31- WT NT -S	2,1W	3000K	54°	700mA	150Lm	81%	



		+RE	P	CCT	Beam	I	Flux	LOR
FIT 020 48V Double	A344-1- 00 -10- WT NT -S	4,2W	2700K	12°	700mA	2 x 127Lm	87%	
	A344-1- 00 -11- WT NT -S	4,2W	3000K	12°	700mA	2 x 150Lm	87%	
	A344-1- 00 -20- WT NT -S	4,2W	2700K	30°	700mA	2 x 127Lm	88%	
	A344-1- 00 -21- WT NT -S	4,2W	3000K	30°	700mA	2 x 150Lm	88%	
	A344-1- 00 -30- WT NT -S	4,2W	2700K	54°	700mA	2 x 127Lm	81%	
	A344-1- 00 -31- WT NT -S	4,2W	3000K	54°	700mA	2 x 150Lm	81%	



ACCESSORY

FIT 035 Anti-glare Honeycomb Louver **
A345-00-00

NOT SOLD SEPARATELY



00	*OPTIONS
1	No DIM
2	DIM DALI

+RE	REF. ENDING	EXAMPLE
0	Track 48V	A3450110WT
-S	Track 48V Short	A3450110WT-S

00	*OPTIONS
1	No DIM
2	DIM DALI

+RE	REF. ENDING	EXAMPLE
0	Track 48V	A3440110WT
-S	Track 48V Short	A3440110WT-S

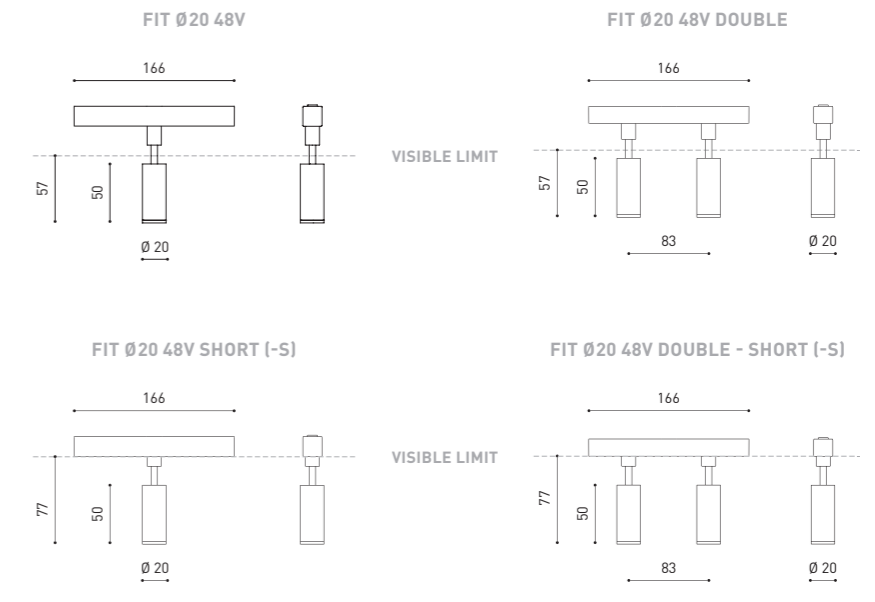
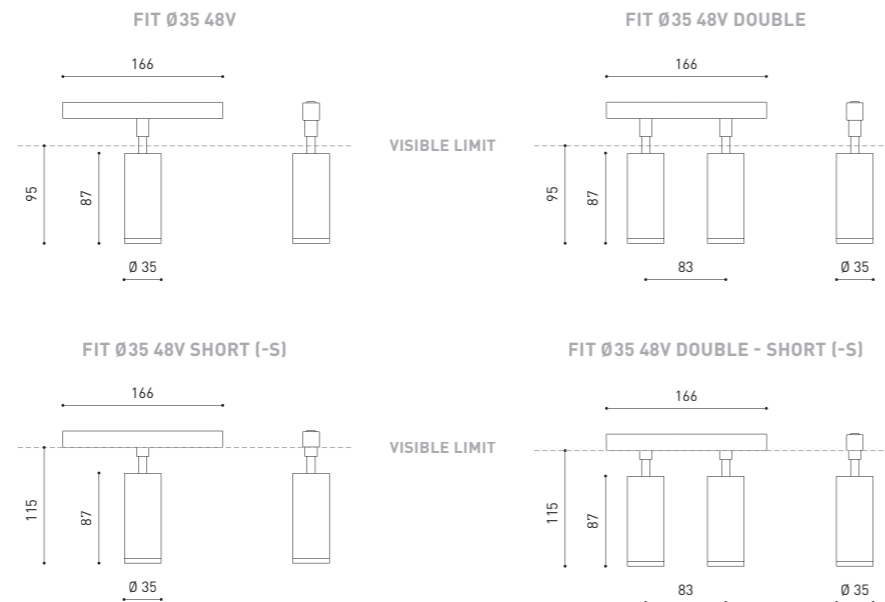

COLOUR | WT □ RAL 9016 | NT ■ RAL 9005 | MATERIAL | AL | PC | ⓘ » 48

** ACCESSORY AFFECTS THE LIGHTING PARAMETERS
+RE >> THE PRODUCTS FOR THE TRACK 48V SHORT, ADD "-S" AT THE END OF THE SALES REFERENCE
(AFTER THE LETTERS WHICH INDICATE THE COLOUR OF THE PRODUCT).

» PLEASE CONSULT

COLOUR | WT □ RAL 9016 | NT ■ RAL 9005 | MATERIAL | AL | PC | ⓘ » 48

+RE >> THE PRODUCTS FOR THE TRACK 48V SHORT, ADD "-S" AT THE END OF THE SALES REFERENCE
(AFTER THE LETTERS WHICH INDICATE THE COLOUR OF THE PRODUCT).

» PLEASE CONSULT

48V SYSTEM
PLUS 48V



		+RE	P	CCT	Beam	I	Flux	LOR
PLUS 48V	A323-00- 0 -0- WT NT -S	18W	2700K	12°-51°	500mA	1920Lm	26-40%	
	A323-00- 0 -1- WT NT -S	18W	3000K	12°-51°	500mA	2000Lm	26-40%	
	A323-00- 0 -2- WT NT -S	18W	4000K	12°-51°	500mA	2030Lm	26-40%	

LED | 48V | CE | IP20 | CRI>90 | L80B10 >60,000h | MacAdam Step 2 | OPTIONS* | INCL | TRACK 48V OPTIONS RE | 360° | 180° | 12°-51° | 12°-51°

		+RE	P	CCT	Beam	I	Flux	LOR
PLUS Mini 48V	A326-00- 0 -0- WT NT -S	6,5W	2700K	10°-41°	700mA	630Lm	20-40%	
	A326-00- 0 -1- WT NT -S	6,5W	3000K	10°-41°	700mA	660Lm	20-40%	
	A326-00- 0 -2- WT NT -S	6,5W	4000K	10°-41°	700mA	680Lm	20-40%	

LED | 48V | CE | IP20 | CRI>90 | L80B10 >60,000h | MacAdam Step 2 | OPTIONS* | INCL | TRACK 48V OPTIONS RE | 360° | 180° | 10°-41° | 10°-41°

ACCESSORIES

PLUS High Chromatic LED**

PLUS MINI High Chromatic LED**

NOT SOLD SEPARATELY



0	*OPTIONS
1	No DIM
2	DIM DALI

+RE	REF. ENDING	EXAMPLE
0	Track 48V	A3230010WT
-S	Track 48V Short	A3230010WT-S

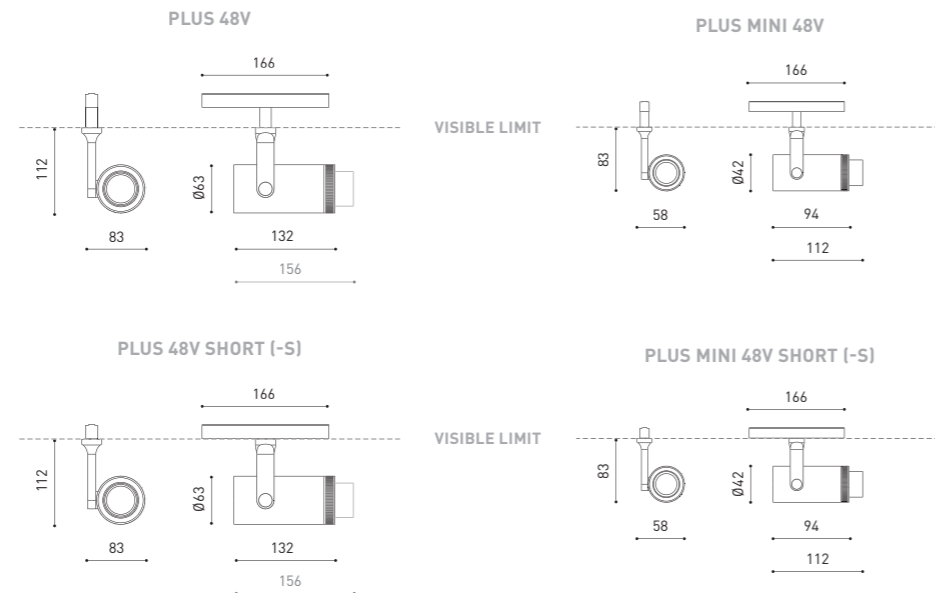

COLOUR | WT □ RAL 9016 | NT ■ RAL 9005 | MATERIAL | AL | OPTICAL GLASS || OPTICAL PMMA | » 48

** ACCESSORY AFFECTS THE LIGHTING PARAMETERS
+RE >> THE PRODUCTS FOR THE TRACK 48V SHORT, ADD "-S" AT THE END OF THE SALES REFERENCE (AFTER THE LETTERS WHICH INDICATE THE COLOUR OF THE PRODUCT).

» PLEASE CONSULT

48V SYSTEM
ZEN TUBE 48V



		+RE	P	CCT	I	Flux	LOR
ZEN TUBE 48V 1	A341-11- 0 -0- WT NT -S	12W	2700K	350mA	1580Lm	90%	
	A341-11- 0 -1- WT NT -S	12W	3000K	350mA	1640Lm	90%	
ZEN TUBE 48V 2	A341-12- 0 -0- WT NT -S	17W	2700K	500mA	2130Lm	90%	
	A341-12- 0 -1- WT NT -S	17W	3000K	500mA	2220Lm	90%	
ZEN TUBE 48V 3	A341-13- 0 -0- WT NT -S	23W	2700K	700mA	3070Lm	90%	
	A341-13- 0 -1- WT NT -S	23W	3000K	700mA	3190Lm	90%	
	A341-23- 0 -0- WT NT -S	23W	2700K	700mA	3070Lm	90%	
	A341-23- 0 -1- WT NT -S	23W	3000K	700mA	3190Lm	90%	

LED | 48V | CE | IP20 | CRI>90 | L80B10 >60,000h | MacAdam Step 2 | INCL | TRACK 48V | 355° | 270° | 16°/24°/42°

0	BEAM OPTIONS
1	16°
2	24°
3	42°

+RE	REF. ENDING	EXAMPLE
0	Track 48V	A3411110WT
-S	Track 48V Short	A3411110WT-S

ACCESSORIES

NOT SOLD SEPARATELY

ZEN High Chromatic LED*

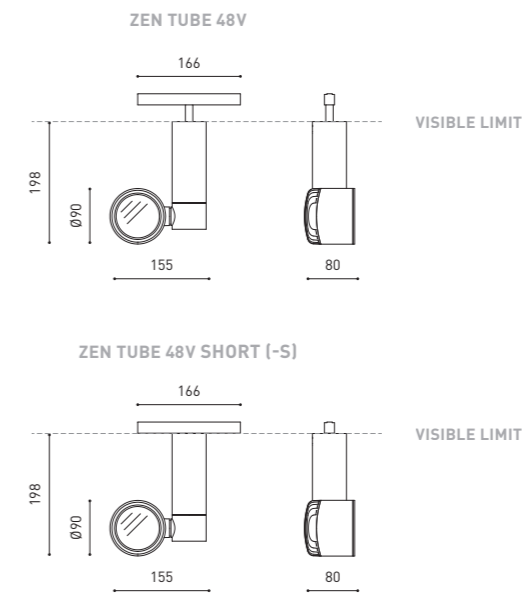

ZEN Anti-glare Honeycomb Louver * 0702-02-00



ZEN Elliptical Refractor * 0700-08-00



ZEN Beam Mixer Diffuser* 0805-02-00



COLOUR | WT □ RAL 9016 | NT ■ RAL 9005 | MATERIAL | AL | GL-TRANS | » 48

* AFFECTS THE LIGHTING PARAMETERS
+RE >> THE PRODUCTS FOR THE TRACK 48V SHORT, ADD "-S" AT THE END OF THE SALES REFERENCE (AFTER THE LETTERS WHICH INDICATE THE COLOUR OF THE PRODUCT).

» PLEASE CONSULT

48V SYSTEM
iO 48V



		+RE	P	CCT	Beam	I	Flux	LOR
iO 48V	A348-0- 00 -10-	WT NT -S	4,5W	2700K	20°	500mA	485Lm	92%
	A348-0- 00 -11-	WT NT -S	4,5W	3000K	20°	500mA	505Lm	92%
	A348-0- 00 -20-	WT NT -S	4,5W	2700K	30°	500mA	485Lm	89%
	A348-0- 00 -21-	WT NT -S	4,5W	3000K	30°	500mA	505Lm	89%
	A348-0- 00 -30-	WT NT -S	4,5W	2700K	56°	500mA	485Lm	86%
	A348-0- 00 -31-	WT NT -S	4,5W	3000K	56°	500mA	505Lm	86%



00	*OPTIONS
1	No DIM
2	DIM DALI

+RE	REF. ENDING	EXAMPLE
0	Track 48V	A3480110WT
-S	Track 48V Short	A3480110WT-S

ACCESSORIES

NOT SOLD SEPARATELY

iO High Chromatic LED**



iO Anti-glare Honeycomb Louver** 0806-00-00 | WT | NT |



iO Beam Mixer Diffuser** 0805-01-00

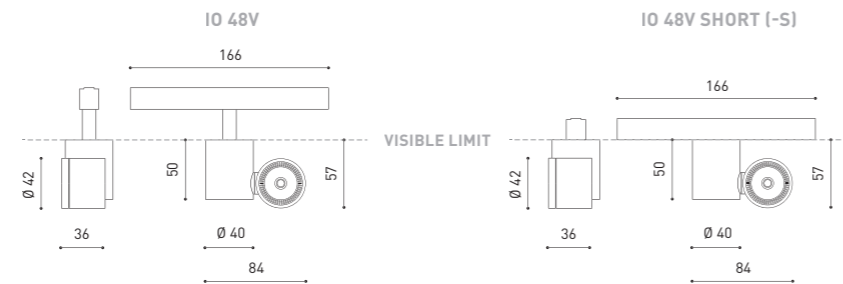

COLOUR | WT □ RAL 9016 | NT ■ RAL 9005 | MATERIAL | AL | PC | » 48

** AFFECTS THE LIGHTING PARAMETERS
+RE >> THE PRODUCTS FOR THE TRACK 48V SHORT, ADD "-S" AT THE END OF THE SALES REFERENCE (AFTER THE LETTERS WHICH INDICATE THE COLOUR OF THE PRODUCT). » PLEASE CONSULT

Private residence (Spain) | Design: Manuel García Asociados | Photography: Diego Opazo Fotografía



48V SYSTEM
LINE 48V



		P	CCT	I	Flux	LOR
LINE 500 48V	A376-10- ① -0- N	10,5W	2700K	350mA	1480Lm	43%
	A376-10- ① -1- N	10,5W	3000K	350mA	1600Lm	43%
LINE 1000 48V	A376-20- ① -0- N	21W	2700K	700mA	2960Lm	43%
	A376-20- ① -1- N	21W	3000K	700mA	3200Lm	43%
LINE 2000 48V	A376-30- ① -0- N	42W	2700K	700mA	5920Lm	43%
	A376-30- ① -1- N	42W	3000K	700mA	6400Lm	43%

48V |
 |
 IP20 |
 CRI>90 |
 L80B10 >60.000h |
 MacAdam Step 2 |
 OPTIONS* |
 INCL |
 TRACK 48V |
 98° |
 98°

① *OPTIONS

1	No DIM
2	DIM DALI

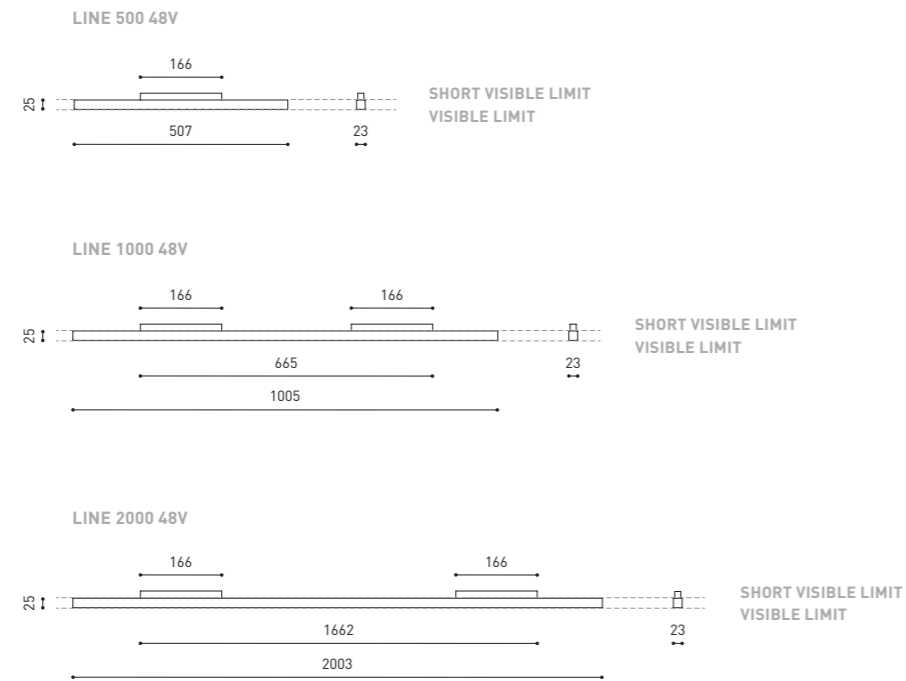

COLOUR | N ■ | MATERIAL | AL | PC | » 48

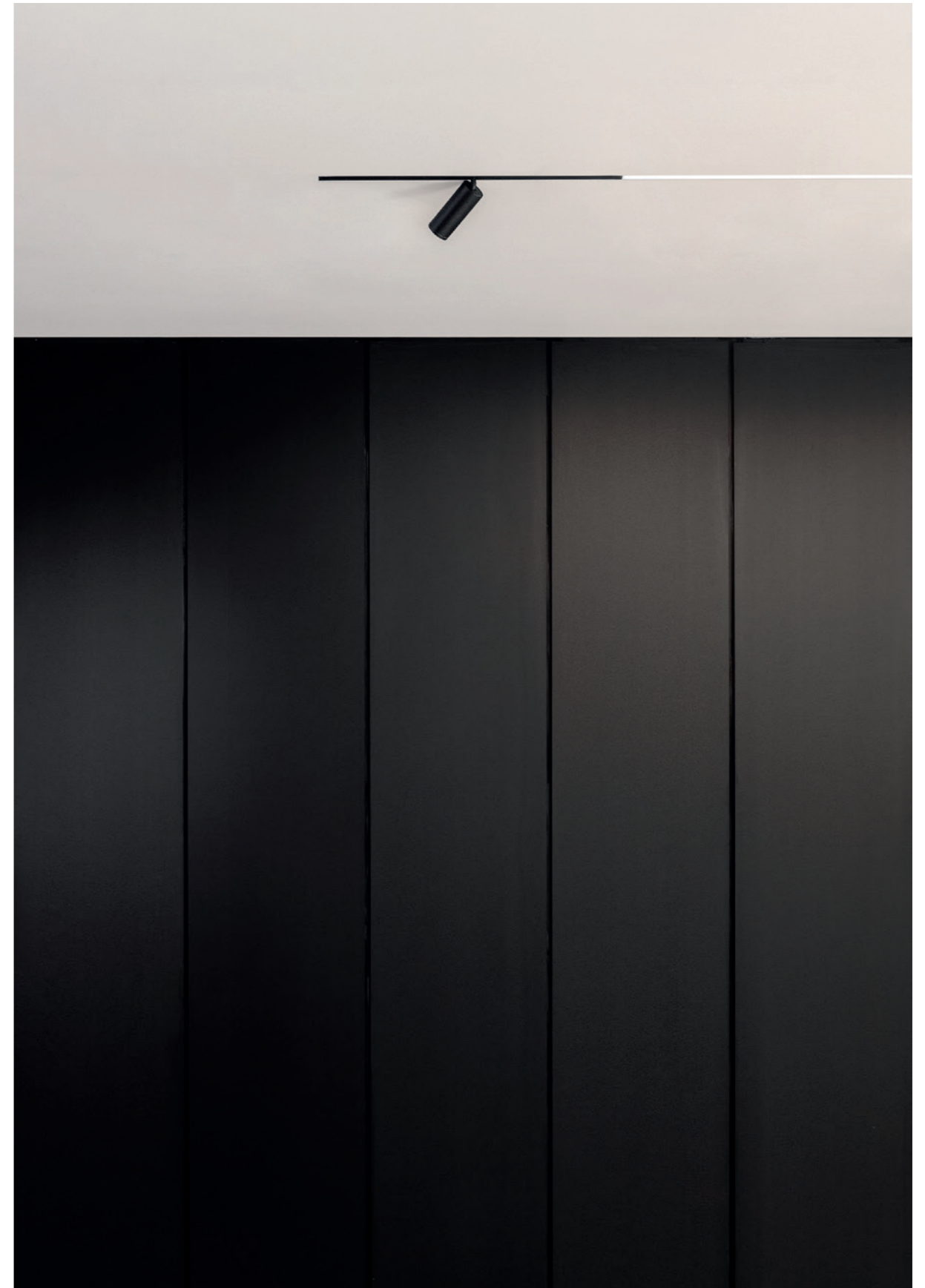

48V SYSTEM
TOP 48V



	+RE	P	CCT	Beam	I	Flux	LOR
TOP 48V	A339-0- Ⓞ -10- WT NT -S	6,5W	2700K	20°	700mA	610Lm	92%
	A339-0- Ⓞ -11- WT NT -S	6,5W	3000K	20°	700mA	640Lm	92%
	A339-0- Ⓞ -20- WT NT -S	6,5W	2700K	30°	700mA	610Lm	89%
	A339-0- Ⓞ -21- WT NT -S	6,5W	3000K	30°	700mA	640Lm	89%
	A339-0- Ⓞ -30- WT NT -S	6,5W	2700K	56°	700mA	610Lm	86%
	A339-0- Ⓞ -31- WT NT -S	6,5W	3000K	56°	700mA	640Lm	86%

LED | 48V | CE | III | IP20 | CRI>90 | L80B10 >60.000h

MacAdam Step 2 | OPTIONS* | INCL | TRACK 48V OPTIONS RE | UGR <19 | 20° / 30° / 56°

Ⓞ	*OPTIONS
1	No DIM
2	DIM DALI

+RE	REF. ENDING	EXAMPLE
⌀	Track 48V	A3390110WT
-S	Track 48V Short	A3390110WT-S

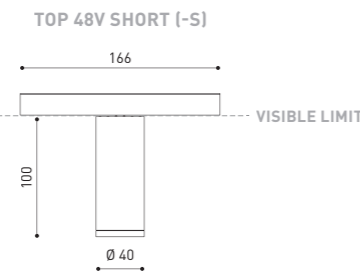
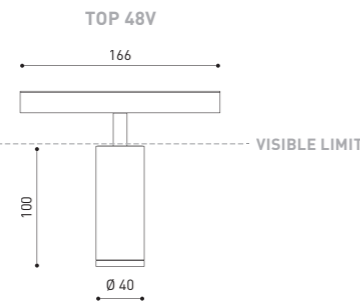

COLOUR | WT □ RAL 9016 | NT ■ RAL 9005 | MATERIAL | AL | PC | ⓘ » 48

** AFFECTS THE LIGHTING PARAMETERS
+RE >> THE PRODUCTS FOR THE TRACK 48V SHORT, ADD "-S" AT THE END OF THE SALES REFERENCE (AFTER THE LETTERS WHICH INDICATE THE COLOUR OF THE PRODUCT). ⓘ » PLEASE CONSULT

ACCESSORIES

NOT SOLD SEPARATELY

TOP High Chromatic LED**



TOP Beam Mixer Diffuser** 0805-01-00



TOP Anti-glare Honeycomb Louver** 0807-00-00 | WT | NT |



	+RE	P	CCT	Beam	I	Flux	LOR
TOP MINI 48V	A340-0- Ⓞ -10- WT NT -S	6,5W	2700K	20°	700mA	610Lm	92%
	A340-0- Ⓞ -11- WT NT -S	6,5W	3000K	20°	700mA	640Lm	92%
	A340-0- Ⓞ -20- WT NT -S	6,5W	2700K	30°	700mA	610Lm	89%
	A340-0- Ⓞ -21- WT NT -S	6,5W	3000K	30°	700mA	640Lm	89%
	A340-0- Ⓞ -30- WT NT -S	6,5W	2700K	56°	700mA	610Lm	86%
	A340-0- Ⓞ -31- WT NT -S	6,5W	3000K	56°	700mA	640Lm	86%

LED | 48V | CE | III | IP20 | CRI>90 | L80B10 >60.000h

MacAdam Step 2 | OPTIONS* | INCL | TRACK 48V OPTIONS RE | UGR <19 | 20° / 30° / 56°

Ⓞ	*OPTIONS
1	No DIM
2	DIM DALI

+RE	REF. ENDING	EXAMPLE
⌀	Track 48V	A3400110WT
-S	Track 48V Short	A3400110WT-S

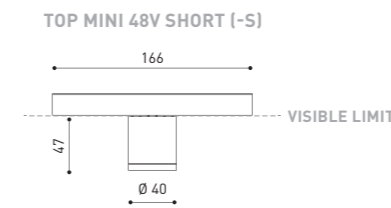
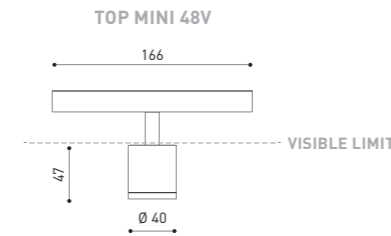

COLOUR | WT □ RAL 9016 | NT ■ RAL 9005 | MATERIAL | AL | PC | ⓘ » 48

** AFFECTS THE LIGHTING PARAMETERS
+RE >> THE PRODUCTS FOR THE TRACK 48V SHORT, ADD "-S" AT THE END OF THE SALES REFERENCE (AFTER THE LETTERS WHICH INDICATE THE COLOUR OF THE PRODUCT). ⓘ » PLEASE CONSULT

ACCESSORIES

NOT SOLD SEPARATELY

TOP High Chromatic LED**



TOP Beam Mixer Diffuser** 0805-01-00



TOP Anti-glare Honeycomb Louver** 0807-00-00 | WT | NT |



48V SYSTEM
HOLLY 48V



		P	CCT	Beam	I	Flux	LOR
HOLLY 48V	A349- ① -1-00- WT NT MC MG	2,1W	2700K	17°	700mA	190Lm	92%
	A349- ① -1-01- WT NT MC MG	2,1W	3000K	17°	700mA	210Lm	92%
DALI	A349- ① -2-00- WT NT MC MG	2,1W	2700K	17°	700mA	190Lm	92%
	A349- ① -2-01- WT NT MC MG	2,1W	3000K	17°	700mA	210Lm	92%
	A349- ① -1-10- WT NT MC MG	2,1W	2700K	35°	700mA	190Lm	93%
	A349- ① -1-11- WT NT MC MG	2,1W	3000K	35°	700mA	210Lm	93%
DALI	A349- ① -2-10- WT NT MC MG	2,1W	2700K	35°	700mA	190Lm	93%
	A349- ① -2-11- WT NT MC MG	2,1W	3000K	35°	700mA	210Lm	93%

LED | 48V | CE | IP20 | CRI>90 | L80B10 > 60.000h

MacAdam Step 3 | INCL | TRACK 48V OPTIONS RE | 17° / 35°

①	CORD LENGTH - L
0	2 m
1	3 m
2	5 m

HOLLY Cord Accessory
0223-00-00- | WT | NT |

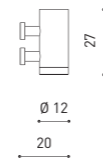

HOLLY 48V TRACK

HOLLY 48V TRACK + CORD ACCESSORY

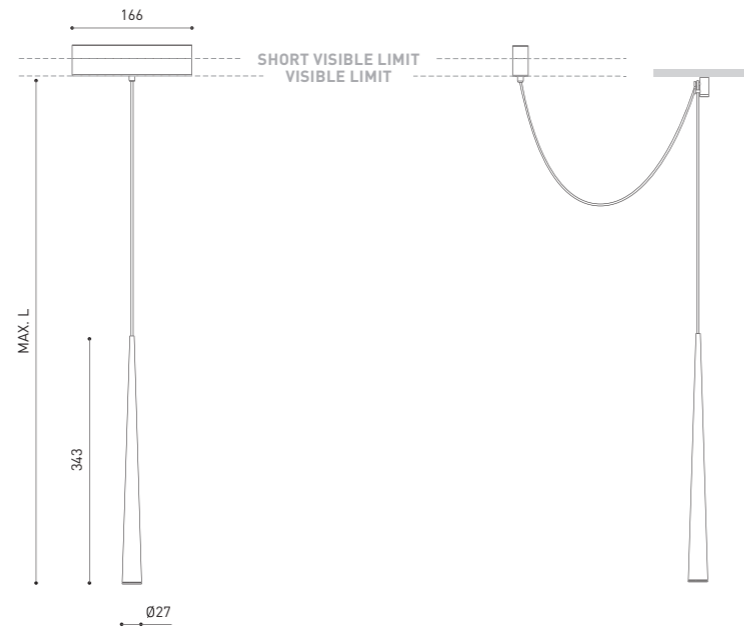

COLOUR | WT □ RAL 9016 | NT ■ RAL 9005 | MC ■ | MG ■ | MATERIAL | AL | ABS | ⓘ » 48

» PLEASE CONSULT

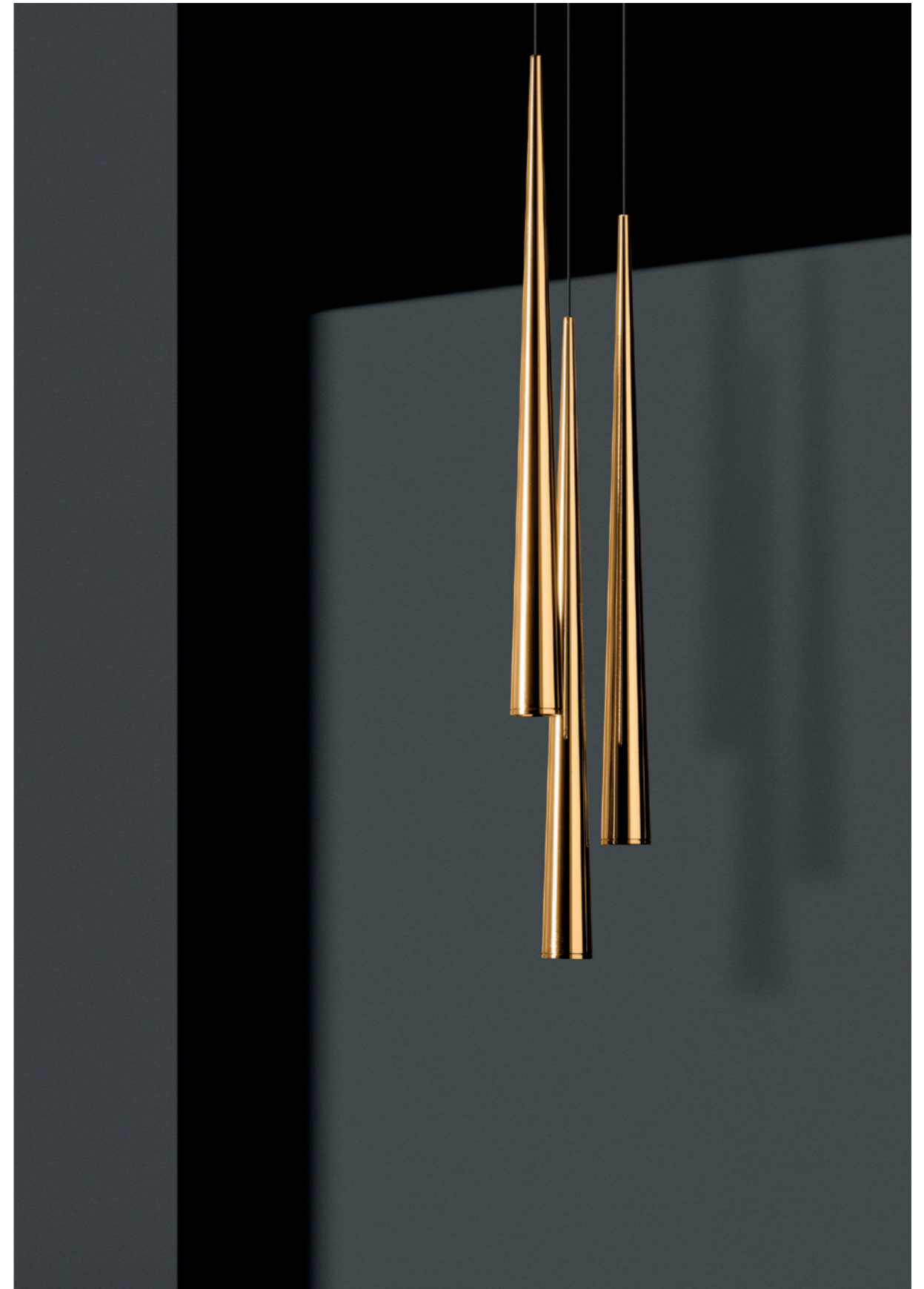

48V SYSTEM
SPIN 48V



		P	CCT	Beam	I	Flux	LOR
SPIN 48V	A350- ① -1-00- WT NT MC MG	6,5W	2700K	24°	700mA	600Lm	86%
	A350- ① -1-01- WT NT MC MG	6,5W	3000K	24°	700mA	630Lm	86%
DALI	A350- ① -2-00- WT NT MC MG	6,5W	2700K	24°	700mA	600Lm	86%
	A350- ① -2-01- WT NT MC MG	6,5W	3000K	24°	700mA	630Lm	86%
DALI	A350- ① -1-10- WT NT MC MG	6,5W	2700K	40°	700mA	600Lm	84%
	A350- ① -1-11- WT NT MC MG	6,5W	3000K	40°	700mA	630Lm	84%
DALI	A350- ① -2-10- WT NT MC MG	6,5W	2700K	40°	700mA	600Lm	84%
	A350- ① -2-11- WT NT MC MG	6,5W	3000K	40°	700mA	630Lm	84%

LED | 48V | CE | IP20 | CRI>90 | L80B10 > 60,000h

MacAdam Step 2 | INCL | TRACK 48V OPTIONS RE | 24° / 40°

①	CORD LENGTH - L
0	2 m
1	3 m
2	5 m

SPIN Cord Accessory
0223-00-00- | WT | NT |

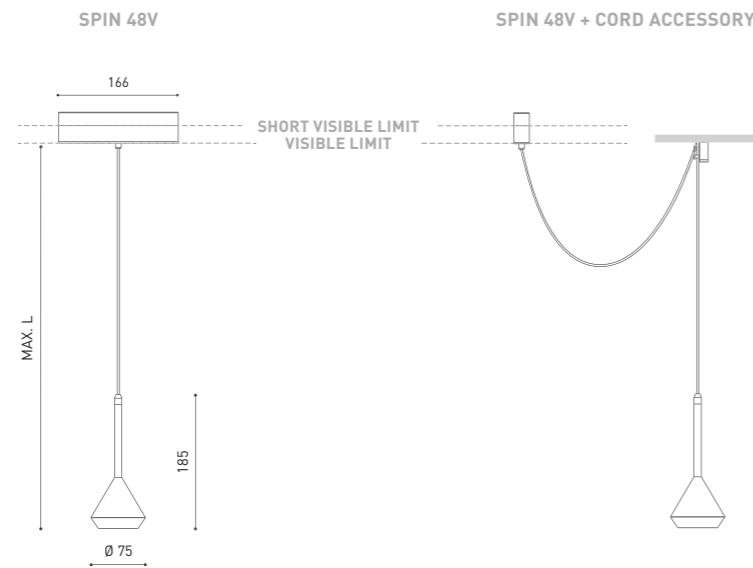
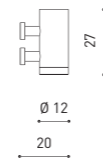





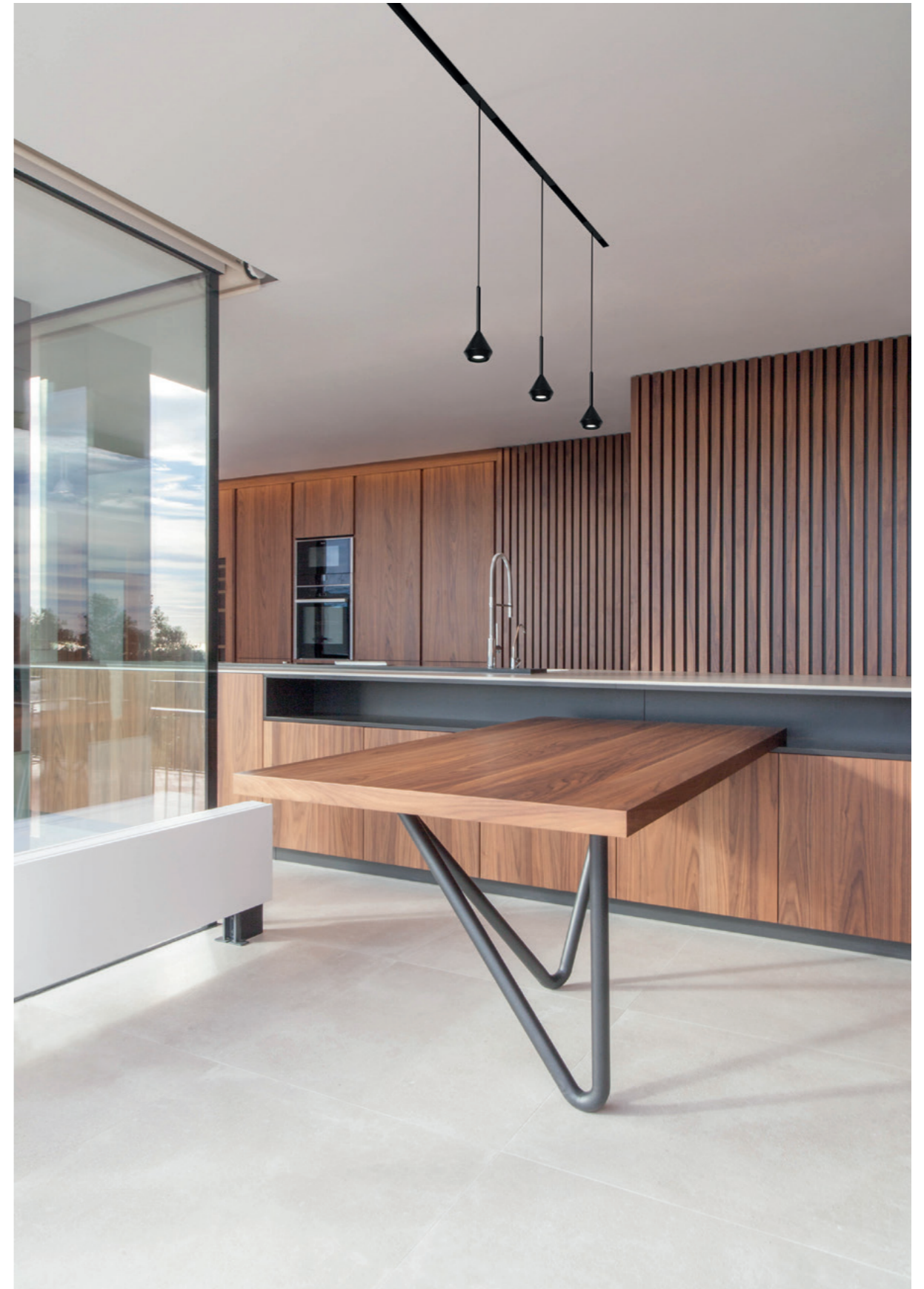















COLOUR | WT □ RAL 9016 | NT ■ RAL 9005 | MC ■ | MG ■ | MATERIAL | AL | PMMA | » 48

» PLEASE CONSULT







Cosmos House (Spain) | Architect: Rubén Muedra Estudio de Arquitectura | Built: AT4 Grupo | Kitchen: Porcelanosa | Photography: Hille Sievers

Glossary

P	Power		Class III
CCT	Colour Temperature		Chromatic stability: MacAdam Steps
I	Current intensity		Dimmable
Flux	Gross luminous flux		Control gear not included
L	Length (in mm)		Electronic equipment included
AL	Aluminium		Elliptical refractor
PC	Polycarbonate		Beam Mixer Diffuser
ABS	Acrylonitrile Butadiene Styrene		Diffuser
LOR	Lumen Output Ratio. Ratio between the output flux of the luminaire and the output flux of the light source		Rail Type
IPXX	Sealing rating		Control through bluetooth
CRI	Color rendering index		Installation type and light beam direction
GL	Glass		UGR (Unified Glare Rating) Visual comfort
PMMA	Polymethyl methacrylate		Made of
TRANS	Transparent		Optical glass
	LED lamp		Tilting angle
48V	Power supply voltage 48vdc		Reflector
	CE marking		Rotation angle
	ENEC certified		

Colours

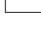
The lighting values indicated for each ref. code correspond to the results obtained from the tests carried out on the first mentioned colour of the list.

	N Matt black = RAL 9005
	NT Textured black = RAL 9005
	B White = RAL 9016
	WT Textured white = RAL 9016
	MG Metallic Gold*
	MC Metallic Copper*

*RAL not available. Paint of metallic nanoparticles.

Special LED

FOR COMMERCIAL PRODUCT SHOWCASING

For some of its products, Arkoslight offers the possibility to provide them with a special LED, designed to create an illumination focused on visually promoting goods or products for commercial purposes. It is a high chromaticity LED, capable of identifying the colour shades that produce a positive psychological perception of the illuminated object.

This special LED lighting source offers a much more attractive and intense colour range than a conventional LED, besides being much wider. Technically, this is possible thanks to a special LED setting that includes a «special saturation parameter», capable of highlighting the objects colours and materials in such a way that they seem more attractive within the visible light spectrum. To achieve this performance, in each case, the appropriate COB and specific phosphor coating are carefully selected.

ARKOSLIGHT®

Calle N · Pol. Ind. EL OLIVERAL
46394 Ribarroja del Turia · Valencia (Spain)
Tel. +34 961 667 207 · Fax +34 961 667 054
info@arkoslight.com · www.arkoslight.com
France: +33 182 885 200 · Italia: +39 02 9475 0007
Deutschland: +49 22 182 829 313





LIGHT&LIFE
— DESDE 1984 —