

SHADOWLINE

LED LINEAR RECESSED TRACK SYSTEM
INSTALLATION INSTRUCTIONS

RECESSED TRACK - COMPONENTS

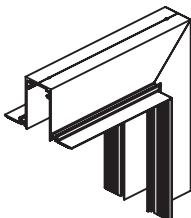
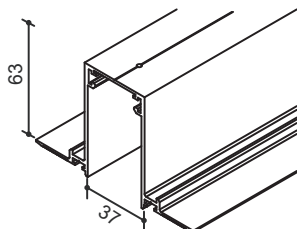

Product code	Length
10-RDS	1500mm
20-RDS	2000mm
30-RDS	2500mm

Product code	
40-RDS	RECESSED Vertical corner

Product code	
50-RDS	RECESSED Horizontal corner

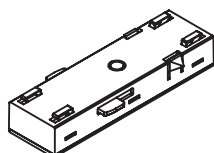

A10-CDS
Recessed straight circuit joint

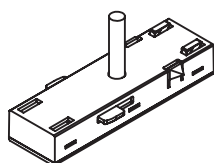

A20-CDS
Recessed straight circuit joint 2m power cable

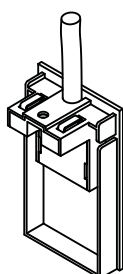

30-CDS
End cap 2m power cable

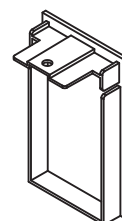

40-CDS
End cap

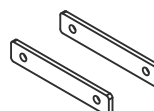

50-CDS
2 x Reinforced joint

RECESSED TRACK - INSTALL INSTRUCTIONS

1

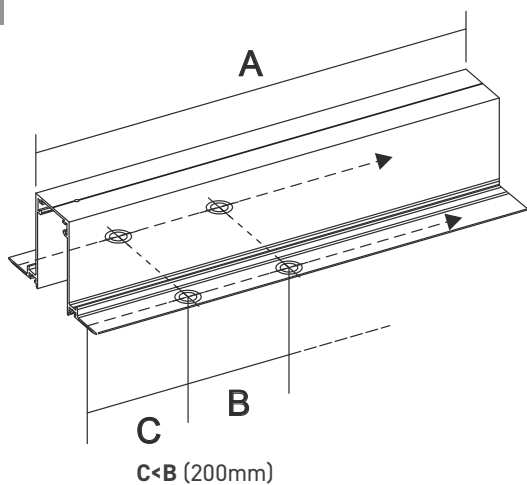

Product code	A	B
10-RDS	1500mm	200mm x 8
20-RDS	2000mm	200mm x 12
30-RDS	2500mm	200mm x 16

2

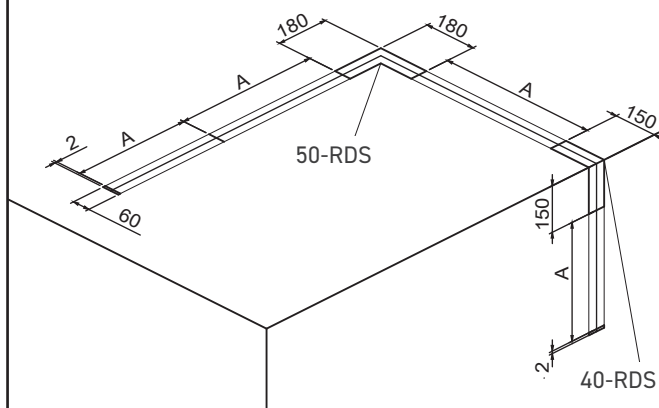

3

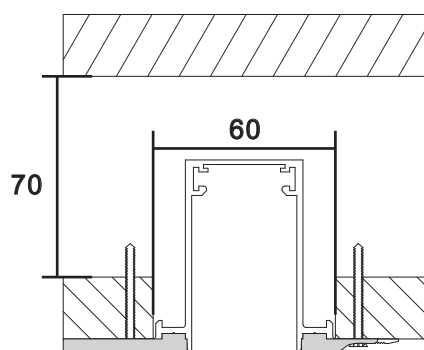

4

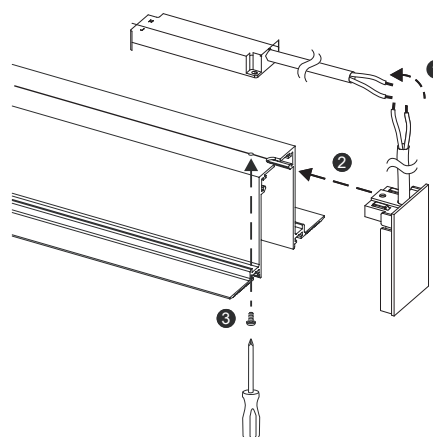

30-CDS End cap 2m power cable

5

A20-CDS
Recessed straight
circuit joint
2m power cable

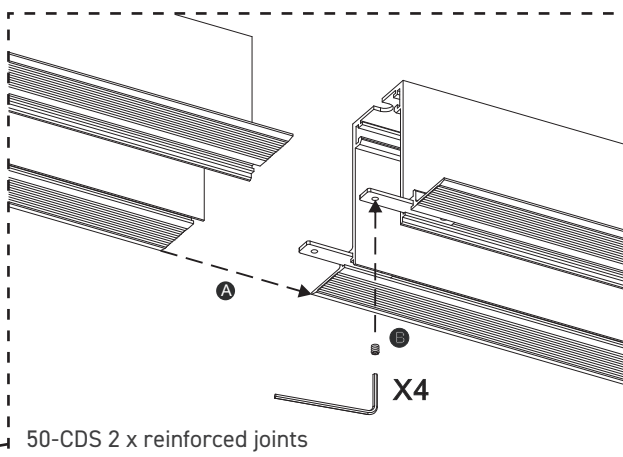
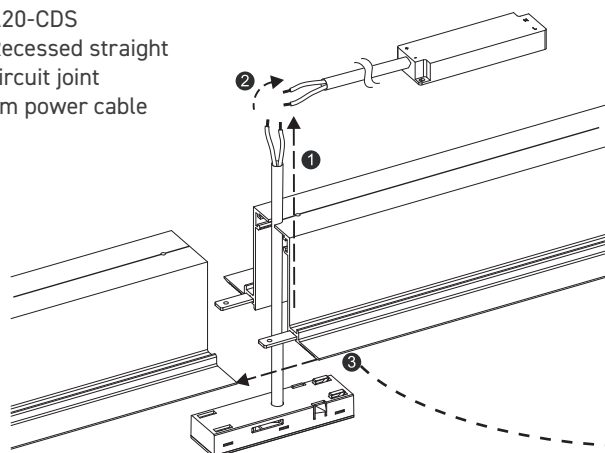

50-CDS 2 x reinforced joints

RECESSED TRACK - INSTALL INSTRUCTIONS

6

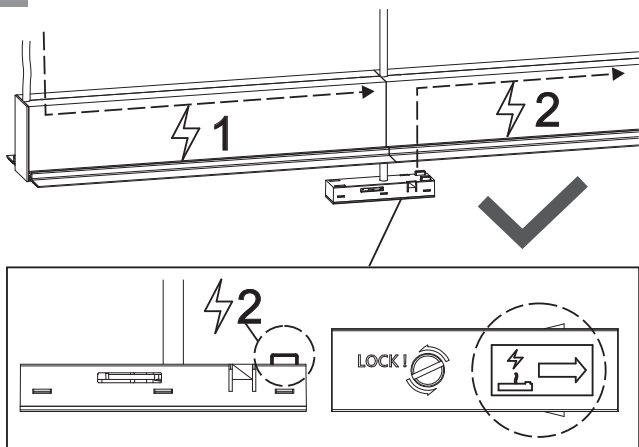

A20-CDS Recessed straight circuit joint 2m power cable

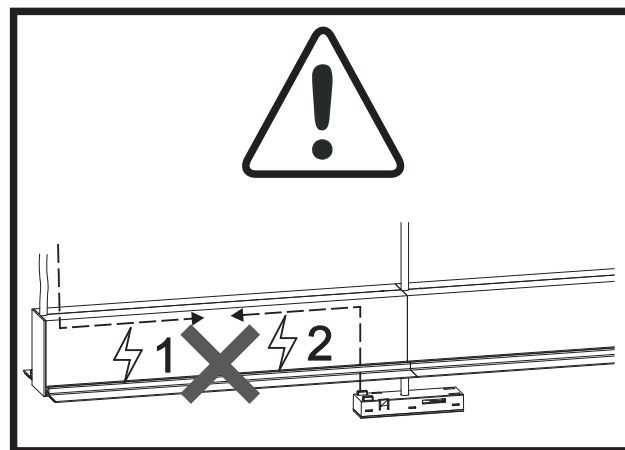

7

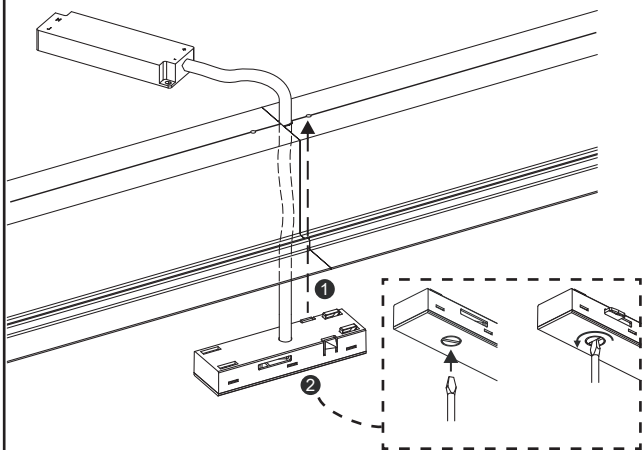

A20-CDS
Recessed straight circuit joint 2m power cable

8

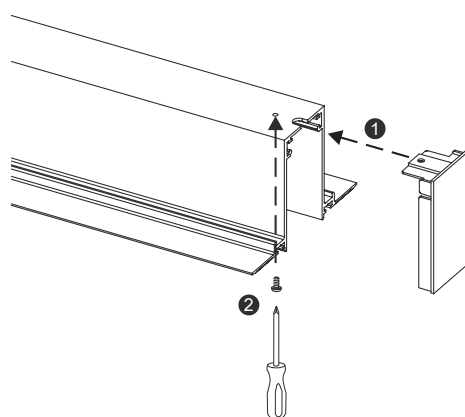

40-CDS End cap

9

A10-CDS Recessed straight circuit joint

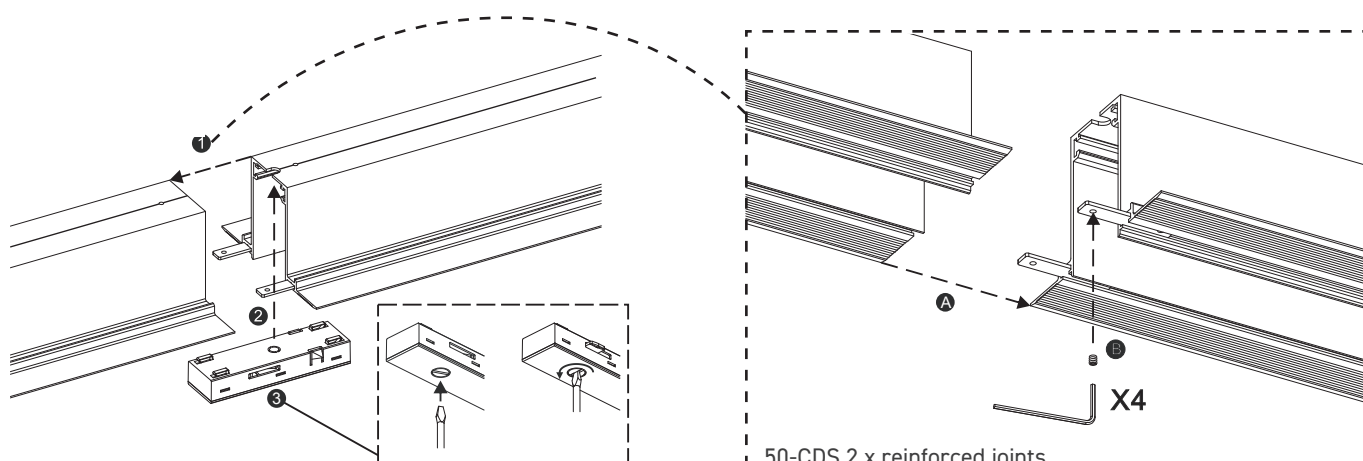

50-CDS 2 x reinforced joints

RECESSED TRACK - INSTALL INSTRUCTIONS

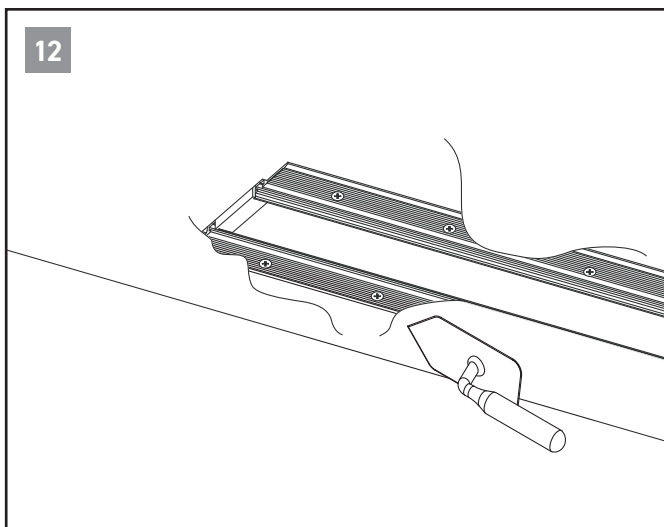
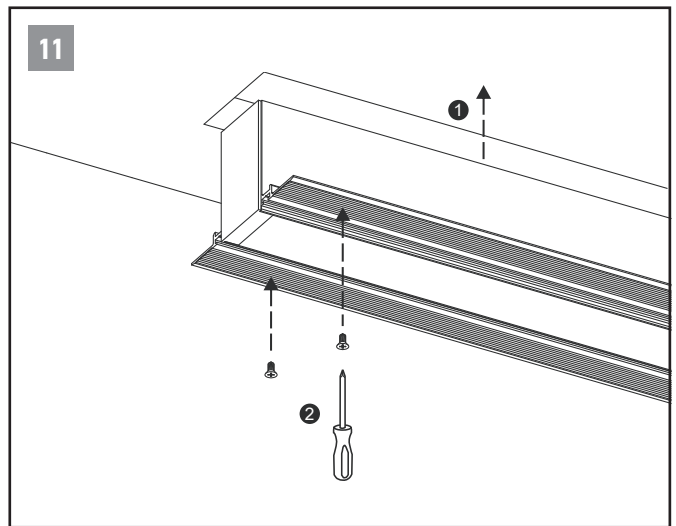
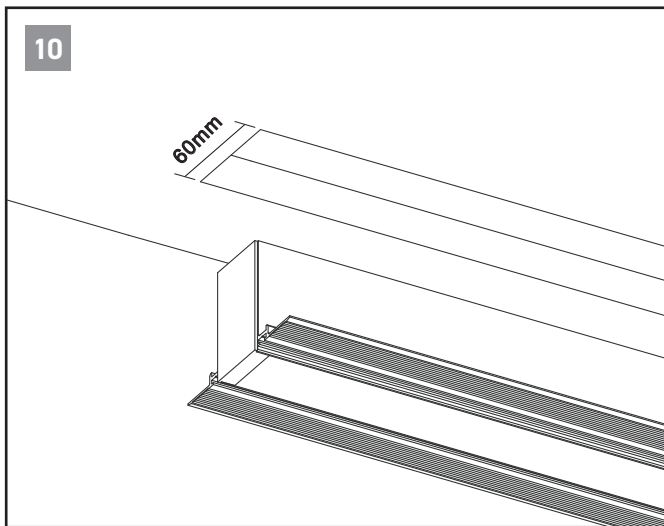

01189 889414



sales@darklightdesign.com



darklightdesign.com

Darklight Design
Unit 10 Brookside Business Centre
Church Road
Swallowfield
Reading
Berkshire
RG7 1TH