

**&tradition<sup>®</sup>**  
COPENHAGEN



---

# MARBLE LIGHT SV1-2-3-4-5

by Studio Vit

---

## USER INSTRUCTIONS

[andtradition.com](http://andtradition.com)

Congratulations on choosing this original Marble Light designed by Studio Vit. We hope you will enjoy using this product and follow these instructions to ensure correct installation. If you have any questions or comments, please do not hesitate to contact us by mail on:  
[info@andtradition.com](mailto:info@andtradition.com)

# Contents:

- A** - Glass shade
- B** - 4 meter fabric cord fitted with G9 lamp holder
- C** - Marble piece
- D** - G9 light bulb

**Please read these instructions carefully and retain them for future reference to ensure that the lamp is correctly installed should it be moved or sold. For your own safety, please study each step of this instruction manual before you commence installation. &Tradition are not responsible for any faults or damages caused by not following these instructions correctly. Do not modify this lamp in any way.**

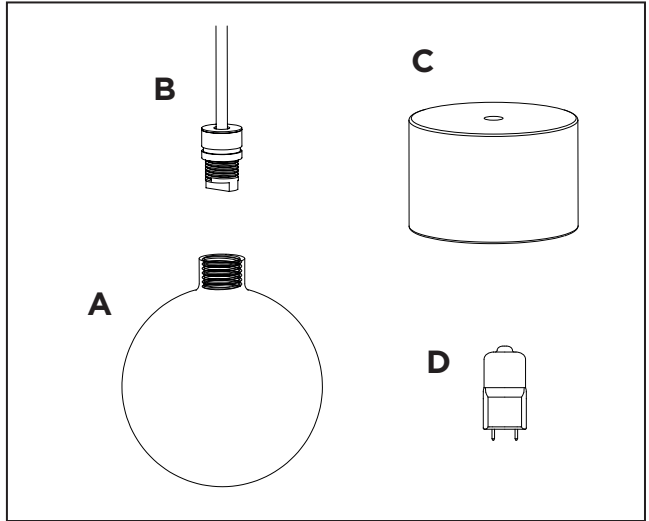

# Safety Precautions:

- Dispose of plastic bag from packaging and do not allow children to play with it.
- Keep product well out of children's reach.
- The lamp is only intended for interior use.
- Lamp exterior gets hot after prolonged use
- Do not attempt installation of product if you are not competent to do so yourself.
- Consult a professionally qualified electrician if in any doubt.
- Disconnect the electricity supply at the fuse box, before comencing work.

# Cleaning Instructions:

- Wipe surface of the lamp with a soft dry cloth.
- Do not use any abrasive cleaning tools such as steel wool, scouring sponges or stiff brushes.

# 01.

Pass the cable through the marble piece and connect to the power supply.

**NB:** ensure the power supply is turned off!

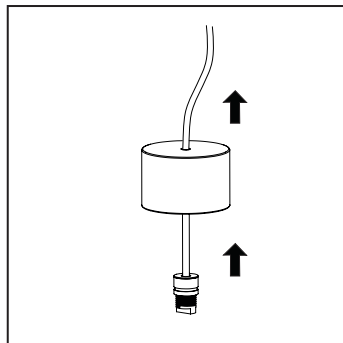

# 02.

Install the G9 light bulb.

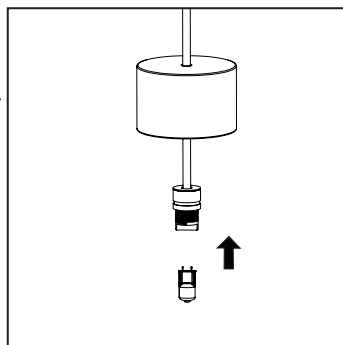

# 03.

Lift up the marble and screw the glass onto the G9 lamp holder.

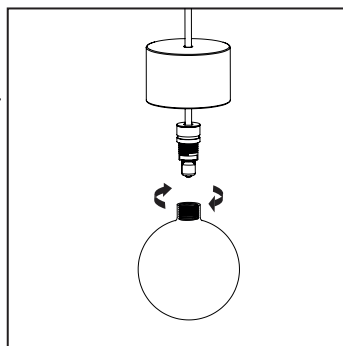

# 04.

Carefully lower the marble piece. Switch on the power supply at the fusebox and enjoy your new lamp.

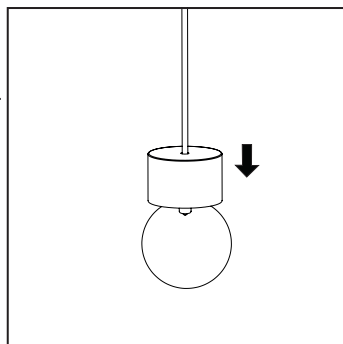

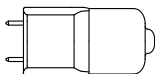

Maximum 25 W.  
G9 bulb.



**&tradition<sup>®</sup>**  
COPENHAGEN

KONGEVEJEN 2. DK-3480 FREDENSBORG.

T. +45 39200233 F.+45 39200256

**INFO@ANDTRADITION.DK WWW.ANDTRADITION.COM**