

Technical Data Sheet

Last data update

4/1/2016

9010
novantadieci®



Req. space behind the plasterboard

100mm

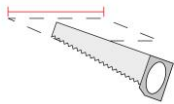

hole on the plasterboard

585x585mm

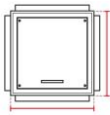

External measures

580x580mm



Height without electrical part

50mm



Height including the electrical part

95mm

Notes on measures

General notes

SONORE

M900A-00

Accessorry / CRISTALY

Surface finish : CRISTALY

Senza parte elettrica - Without electrical part - / -

Model

Code	M900A
Product family	SONORE
Type	Accessorry

Material/Surface finish

Code	004
Material	CRISTALY
Surface finish	CRISTALY

Dati sistema Sonore

Subwoofer

N° Driver	1
Impedenza	4 Ohm
Potenza nominale	60 WRMS per canale
Potenza di picco	120 W max per canale
Sensibilità	\
Risposta in Frequenza	25-200 Hz

Centralina

Passa Basso	200Hz
Passa Alto	200Hz
Ingresso	da amplificatore esterno

General Data

Protection Index

Isolation Class

Weight [Kg]	16
Country of production	MADE IN ITALY
Mounting instruction	025.537_9010_REV01

Installation

Multisize system	SI
Position	Wall/Ceiling lighting

Packaging

Type	White american Box
Measures AxBxH	710x710x215mm
Gross Weight [Kg]	18,222
Master carton	NO
Quantity of articles	
Measures AxBxH	