

Technical Data Sheet

Last data update

3/15/2016

9010
novantadieci®

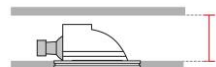

Req. space behind the plasterboard

85mm

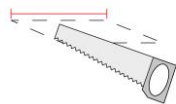

hole on the plasterboard

125x160mm

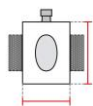

External measures

120x155mm

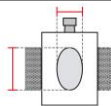

Measures of the light output

55x95mm

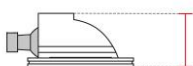

Height without electrical part

75mm

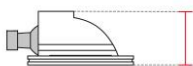

Height including the electrical part

75mm

Notes on measures

General notes

PASSO

4164-35

Recessed Spotlight / CRISTALY

Surface finish : CRISTALY

GU10 ø50 MAX 10W / 240V

Model

Code	4164
Product family	PASSO
Type	Recessed Spotlight

Material/Surface finish

Code	004
Material	CRISTALY
Surface finish	CRISTALY

Electrical part

Code	35
Type	GU10 ø50
Power	MAX 10W
Tension	240V
Light Output	-----
Colour Temperature	-----
CRI	-----
Light Output of the lamp	
Dimmable	NO
Power Supply	Tension
Connection	2 Silicon cables
Cover	

General Data

Protection Index	IP20
Isolation Class	II
Weight [Kg]	0,85
Country of production	MADE IN ITALY
Mounting instruction	025.413_9010_REV04

Installation

Multisize system	NO
Position	Wall pathmarker

Packaging

Type	White die-cut Box
Measures AxBxH	195x195x127mm
Gross Weight [Kg]	0,949
Master carton	NO
Quantity of articles	
Measures AxBxH	

Technical Data Sheet

4164-35

Fotometric Data

Electrical part		Im	illuminance
Power			
Light Output			
Colour Temperature			
CRI			
Lamp Light Output	%		
Light Output of the lamp			
Beam Angle			
Beam Inclination			

Accessories

Housing Box for Brickwork

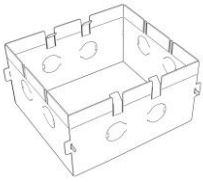

Code 023.446
Measures 125X225X85mm
Measures of the hole on 155X255X95mm

LED bulbs



Code L001-3018
Power 8W
Tension 220-240V
Flux 650lm
CRI 85
Colour Temperature 3000°K
Beam Angle 60°

Code L002-3020
Power 8W
Tension 220-240V
Flux 650lm
CRI 85
Colour Temperature 3000°K
Beam Angle 30°

Code L003-3022
Power 12W
Tension 220-240V
Flux 1000lm
CRI 85
Colour Temperature 3000°K
Beam Angle 60°

Code L004-3018
Power 12W
Tension 220-240V
Flux 1000lm
CRI 85
Colour Temperature 3000°K
Beam Angle 30°

Other Accessories

Code 021.231
Description GU5.3 Lampholder
Notes