

# Technical Data Sheet

Last data update

3/15/2016

9010  
novantadieci®



*Req. space behind the plasterboard*

75mm

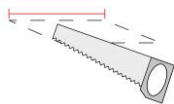

*hole on the plasterboard*

85x105mm

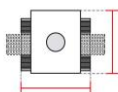

*External measures*

115x100mm

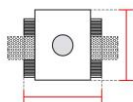

*Measures of the light output*

ø30mm

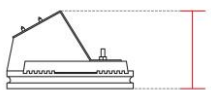

*Height without electrical part*

65mm

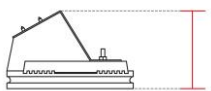

*Height including the electrical part*

65mm

## Notes on measures

## General notes

## PASSO

4099-2700

Recessed Spotlight / CRISTALY

Surface finish : CRISTALY

LED 2W / 24Vdc / 190lm / 2700°K / CRI85

## Model

Code	4099
Product family	PASSO
Type	Recessed Spotlight

## Material/Surface finish

Code	004
Material	CRISTALY
Surface finish	CRISTALY

## Electrical part

Code	2700
Type	LED
Power	2W
Tension	24Vdc
Light Output	190lm
Colour Temperature	2700°K
CRI	85
Light Output of the lamp	60,8lm
Dimmable	SI
Power Supply	by Remote Power Supply
Connection	2 PVC cables
Cover	

## General Data

Protection Index	IP20
Isolation Class	III
Weight [Kg]	0,5
Country of production	MADE IN ITALY
Mounting instruction	025.316_9010_REV06

## Installation

Multisize system	NO
Position	Wall pathmarker

## Packaging

Type	White die-cut Box
Measures AxBxH	195x145x115mm
Gross Weight [Kg]	0,5667
Master carton	NO
Quantity of articles	
Measures AxBxH	

# Technical Data Sheet

4099-2700

## Fotometric Data

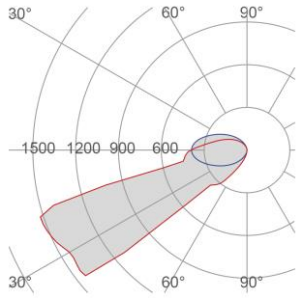

*Electrical part* 2700\_C  
*Power* 2W  
*Light Output* 190lm  
*Colour Temperature* 2700°K  
*CRI* 85

*Illuminance* 0.3m 1030lux  
0.5m 371lux  
1m 93lux

*Lamp Light Output* 32%  
*Light Output of the lamp* 60,8lm  
*Beam Angle* 28°  
*Beam Inclination* 63°

## Accessories

### Housing Box for Brickwork

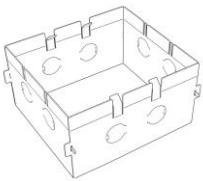

*Code* 023.411  
*Measures* 105X115X70mm  
*Measures of the hole on* 135X145X80mm

## Standard Power Supply

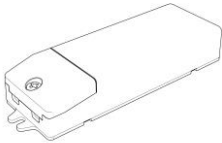

*Code* 026.258  
*Measures* 130x42x23mm  
*Power* 12W  
*Input* 220-240V~W  
*Output* 24Vdc

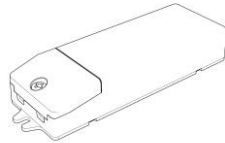

*Code* 026.259  
*Measures* 167x45x30mm  
*Power* 36W  
*Input* 220-240V~W  
*Output* 24Vdc



*Code* 026.260  
*Measures* 157x54x36mm  
*Power* 60W  
*Input* 220-240V~W  
*Output* 24Vdc

## Dimmable Power Supply

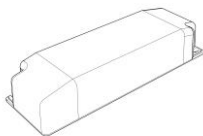

*Code* 026.219  
*Measures* 155x51x26mm  
*Power* 21,6W  
*Input* 220-240V~W  
*Output* 24Vdc  
*Dimmable* PUSH/0-10V/DALI

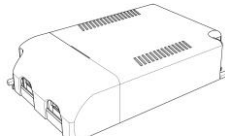

*Code* 026.209  
*Measures* 125x82x29mm  
*Power* 60W  
*Input* 220-240 V~W  
*Output* 24Vdc  
*Dimmable* PUSH/1-10V

---

## Accessories

---

### Other Accessories

---



<i>Code</i>	099.142
<i>Description</i>	Emergency Kit
<i>Notes</i>	