

Step Lite Louvre PURE LED

Cat. No. SLLU/L

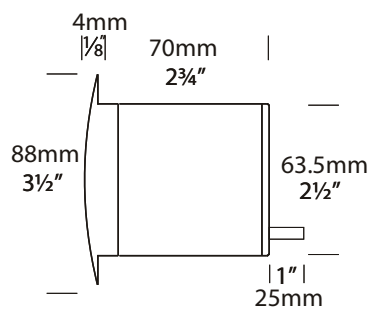

316 Stainless Steel

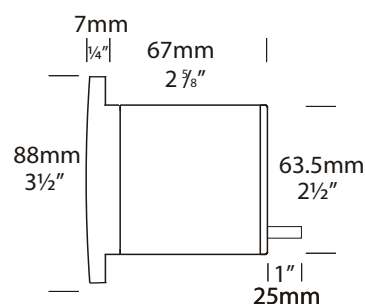

Copper



PURE LED Pure Performance

The Step Lite Louvre has a flush to the surface look with no protrusions. The 45 degree louvre eliminates all upward light, making this luminaire ideal for providing illumination of steps and low level features such as exterior paved areas.

The Hunza PURE LED system uses the latest Cree MTG-2 LED chips for maximum performance and long life. Power supply options include a choice of integral 12 volt driver or an external remote driver. The PURE LED system incorporates an innovative Plug-and-Play system for easy replacement or upgrade of either the LED engine or integral driver.

* At 700mA this fitting is the equivalent of a 35w halogen fitting.

* At 1050mA this fitting is the equivalent of a 50w halogen fitting.

Ordering Information

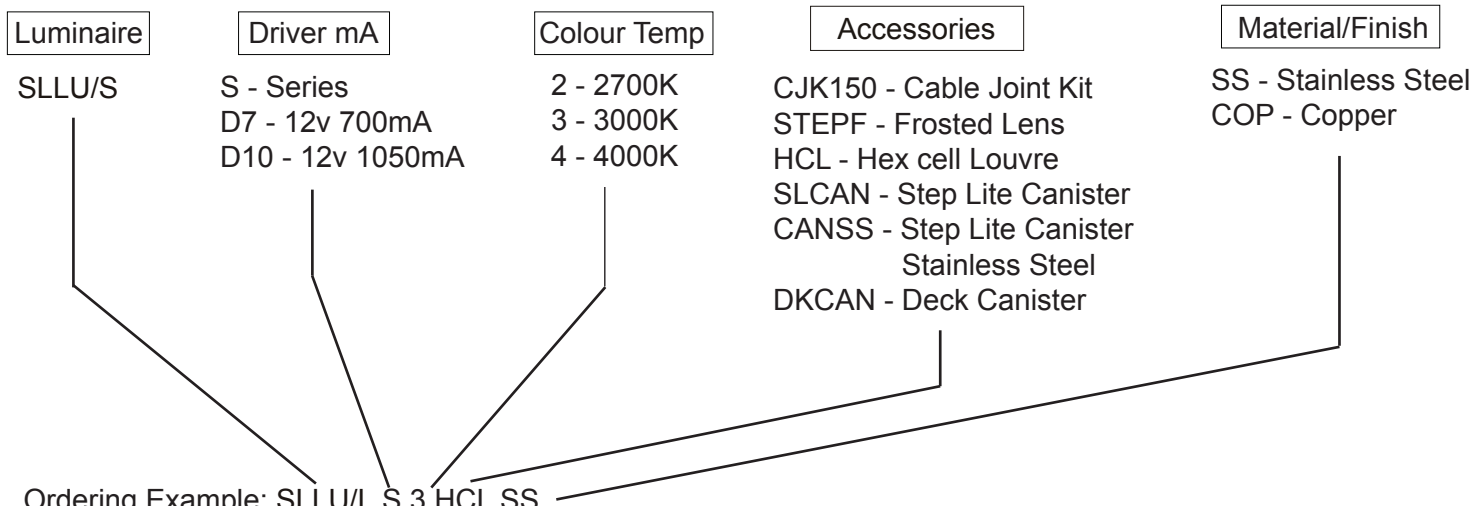

HUNZA™ PURE OUTDOOR LIGHTING

HUNZA FACTORY
130 Felton Mathew Ave
Saint Johns
Auckland 1072
New Zealand

Ph: 64-9-528 9471
Fax: 64-9-528 9361
hunza@hunza.co.nz
www.hunza.co.nz

INTERNATIONAL CONTACTS:
www.hunza.co.nz/contacts.php

Specifications may change without notice.
Manufactured in New Zealand.
© 2015 Hunza Holdings Ltd.

CNC machined from one of the following metals:

Copper: 63.5mm (1/2") x 10mm (13/32"). End cap - solid copper 63.5mm (2 1/2") rod. Flange 88mm (1/2") solid copper rod.

316 Stainless steel: 9mm (11/32"). End cap - solid 316 stainless steel 63.5mm (2 1/2") rod. Flange 88mm (1/2") solid 316 stainless steel rod.

Luminaire Weight

Cop 1.100kg (2lb 6oz)
SS 1.055kg (2lb 5oz)

Luminaire Features

Lens:

3mm (1/8") extra clear low iron flush fit shatter resistant glass. Lifetime Warranty.

Gasket:

Silicone, iron impregnated 220°C (428°F)

Accessories

Cable Joint Kit (Cat. CJK150)
Frosted Lens (Cat. LENSSTEPF)
Hex Cell Louvre (Cat. HCL)
Step Canister (Cat. SLCAN)
316 Stainless Canister for use in lime stone etc. (Cat. CAN)

Mounting

Designed to fit through a 66mm (2 5/8") hole and be fixed into position by two screws in the flange or a Step Lite canister (see accessories) can be used which maintains the aesthetic look of the flange by eliminating the two screw holes in the flange.SS)

Technical Information

Standards

AS/NZS 61046
IP56/IP66 UL 1838

LED

Cree MTG-2 Plug and Play, field replaceable LED board.

Lumen Output: 600 at 1050mA
Lumens Per watt: 100 at 6 watts
CRI Warm White (3000k): 85+
Colour Temp: 2700K, 3000K and 4000K

Power Supply

Series (External) Driver

Constant current driver
Output: 6vdc at 1050mA maximum

Integral 12 Volt Driver

Hunza™ Plug and Play Driver
Input: 12vac, 7 watt total
Output: 6vdc nominal, 350 / 700 / 1000mA

Transformer

Hunza™ Wall Mount Transformer for use with integral 12 volt driver