

ARISTOTELE

Aristotele Prodotto | Product

UPDATE

Materiale
 Material

Corpo in alluminio anticorrosivo
 Anticorrosive aluminium body

Staffa in acciaio inox satinato
 Satinized stainless steel bracket

Diffusore in PMMA opalino
 Opal PMMA diffuser

Pot. Assorbita
 Abs. Power

1 x 9W

Collegamento
 Connection

24Vdc - Parallelo | Parallel
230Vac - Tensione di rete | Mains voltage

Cablaggio
 Wiring

Fornito con 25 cm di cavo e
 Provided with 25 cm cable and
WP System o X-Dry
Installazione
 Installation

A terra, parete o soffitto con staffa (inclusa)
 Floor, wall or ceiling mounting with brackets (included)

A terra con picchetto (non incluso)
 On ground with peg (not included)

Alimentatore
 Power supply

24Vdc (Non incluso | Not included)
Finitura
 Finishing

- .01 Alluminio anodizzato** | Anodized aluminium
- .02 Bianco opaco** | Matt white RAL9003
- .08 Nero opaco** | Matt black RAL9005
- .09 Corten**

Disponibile su richiesta
 Also available

 5000 K (Solo versione 24Vdc | 24Vdc version only)
 Dimmerabile | Dimmable

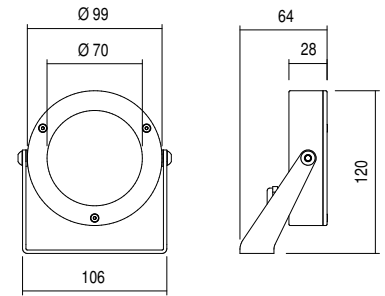
Lunghezza cavo su misura senza WP System o X-Dry p.511
 Customized cable length without WP System or X-Dry p.511

Proiettore **IP65** orientabile, da interno o esterno, ideale per l'illuminazione di statue, alberi, ingressi, facciate.
 Adjustable **IP65** projector, for indoor and outdoor applications, ideal for the lighting of statues, trees, entrances, facades.

ARISTOTELE

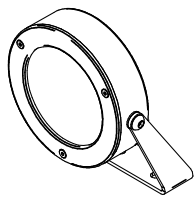

IP65 CE WP XD kg 0 0,57

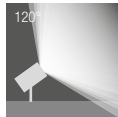

	SUPPLY	W	LM	OPTICS	LED COLOR	CODE	+	FINISHING
	◆ 24Vdc	9	990	120°	3000 K	ARI12234	.	.01 .02 .08 .09
	◆ 24Vdc	9	1080	120°	4000 K	ARI12244	.	.01 .02 .08 .09
	⊕ 230Vac	9	970	120°	3000 K	ARI12334	.	.01 .02 .08 .09
	⊕ 230Vac	9	1060	120°	4000 K	ARI12344	.	.01 .02 .08 .09

ALIMENTATORI OBBLIGATORI | REQUIRED POWER SUPPLIES:

24Vdc (9W) IP67

- AE24018 [18W] (1 Fixture)
- AE24035 [35W] (1/3 Fixtures)
- AE24060 [60W] (1/5 Fixtures)

Composizione <i>Composition</i>	-D1	-D2	-D3	-D4	Sistema di controllo <i>Control System</i>
ARI12234.01-Dx <i>Dimmable power supply</i>	Push	-	DALI	1-10V	Alimentatori dimmerabili p.516 <i>Dimmable power supplies</i>
ARI12234.01-Dx <i>Dimmable 24Vdc controller + 24Vdc power supply</i>	Push	DMX	DALI	1-10V	Centraline 24Vdc dimmerabili p.519 <i>Dimmable 24Vdc Controllers</i>

ACCESSORI | ACCESSORIES

Picchetto | Peg **Code:** PI002

